

---

DEPARTMENT OF  
PUBLIC WORKS

---

GOVERNMENTAL CENTER

JOHN A. FANTHAM  
DIRECTOR OF PUBLIC WORKS



AGENDA: OCTOBER 6, 1998

311

---

COUNTY OF SANTA CRUZ

---

701 OCEAN STREET, SANTA CRUZ, CALIFORNIA 95060-4070

(831) 454-2160

FAX (831) 454-2385

September 28, 1998

SANTA CRUZ COUNTY BOARD OF SUPERVISORS

701 Ocean Street  
Santa Cruz, California 95060

SUBJECT: SUMMIT ROAD CULVERT REPLACEMENT

Members of the Board:

As your Board is aware, last year's storms damaged many roads and culverts throughout the County. One such location is on Summit Road about 1,000 feet east of Soquel - San Jose Road. During the storms the culvert entrance became plugged and water flowed over and onto the roadway causing pavement damage. Also, the culvert is in disrepair and the overlying roadway has experienced extensive settlement due to shifting of the soils alongside the culvert.

In June 1998 the pavement damages were formally addressed by the Federal Emergency Management Agency (FEMA) and a Damage Survey Report was written for pavement repairs. FEMA will not fund replacement of the culvert since it did not actually fail during the storm event. Funding for the culvert replacement is available in the approved 1998/99 Road Budget under Culvert Replacement Program.

The pavement repair project was scheduled for repair along with the other damage sites; however, after preliminary scheduling we received a letter from the Loma Prieta Volunteer Fire and Rescue Team (copy attached) expressing its concerns over the rough road and culvert condition which could result in impaired access to homes during an emergency. County staff made another site visit to inspect the culvert and recommend that the culvert be replaced before this winter's rains.

Because of the need to replace the culvert as soon as possible, Public Works sent plans and requested informal bids from several area contractors who have the skill and availability to expedite the work prior to this winter. Copies of the plans are attached. Bids were requested from Granite Construction Company, Pavex Construction Company, Don Chapin Company, Monterey Peninsula Engineering, and Reber Construction. A pre-bid site visit was scheduled for Friday, October 2.

To expedite the project, Public Works requested that bids be submitted by Monday, October 5, 1998, at 3:00 P.M. Because your Board does not meet Tuesday, October 13, postponing this letter to the next meeting, Tuesday, October 20, would delay the project even further; therefore, the results of the bid opening could not be made a part of this letter. Public Works staff will provide a written report of the bid results at today's meeting.

It is therefore recommended that the Board of Supervisors take the following action:

1. Find that action is necessary to respond to emergency storm damage repair of Summit Road Culvert replacement and that the emergency will not permit a delay resulting from a competitive solicitation for bids.
2. Waive advertising of the bids per Public Contract Code, Sections 20134 and 22050.
3. Approve the attached project plans for culvert replacement and road repair.
4. Allow staff to present written results of informal bids for the project and provide recommendations to your Board for awarding the contract.

Yours truly,

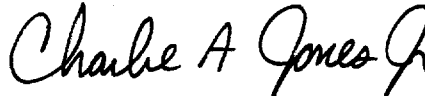
  
For JOHN A. FANTHAM  
Director of Public Works

DJH:mg

Attachments

RECOMMENDED FOR APPROVAL:

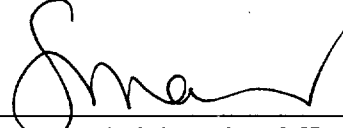
  
\_\_\_\_\_  
County Administrative Officer

Copy to: Public Works  
Saul Wold, Loma Prieta Volunteer Fire and Rescue Team  
Ray Pike, District C Road Superintendent

# **Loma Prieta Vol Fire and Rescue Team**

25050 Highland Way  
Los Gatos, CA 95033

Fire/Medical/Rescue/Disasters  
Volunteers Serving the  
Community



Jan Beautz  
Supervisor, First District

September 11, 1998

Dear Ms. Beautz,

With an understanding of the several reasons that the Highland Way and Mt. Bache Rd. have not been repaired, the Loma Prieta Volunteer Fire & Rescue Team must request special consideration for at least two areas that present safety hazards to fire equipment and personnel.

Near the intersection of Highland Way and Old San Jose Rd. (Soquel Rd.) a condition exists, and has existed, that is a real concern to this department. Although the whole length of the "bad spot" is only about 50 feet, it is so rough that a fire truck could easily be thrown out of control while responding to an emergency. The repair jobs that have taken place have been ineffective. Maybe the original culvert that was washed out last winter should be replaced altogether to fix the problem correctly.

The other area in question is Mt. Bache Rd., approximately ½ mile above the intersection of Highland Way, a condition has existed for three years. Again, the length of the problem area is short (approx. 100 ft.). It is of such a nature that small vehicles can scarcely get through. Large trucks and fire equipment are in jeopardy as they attempt to negotiate the short crossing.

We view these two areas as clear and present hazards. There are others, not so dangerous. We feel that we would not be serving our community if we have knowledge of these dangers and said nothing.

Can you use your good office to speed along permanent repairs to the above described conditions? Thank you for continuing to support and respond to our concerns.

Saul Wold, President  
Loma Prieta Volunteer Fire/Rescue Team

cc: John Fantham, Director, Public Works Department.  
Mountain Network News

COUNTY OF SANTA CRUZ  
DEPARTMENT OF PUBLIC WORKS

PROJECT BURRELL CREEK @  
LOCATION HIGHLAND WAY

CALC BY JTH DATE SEPT 1998  
CHECK BY DATE

SHEET 314 /  
WORK ORDER NO.

CULVERT REPLACEMENT

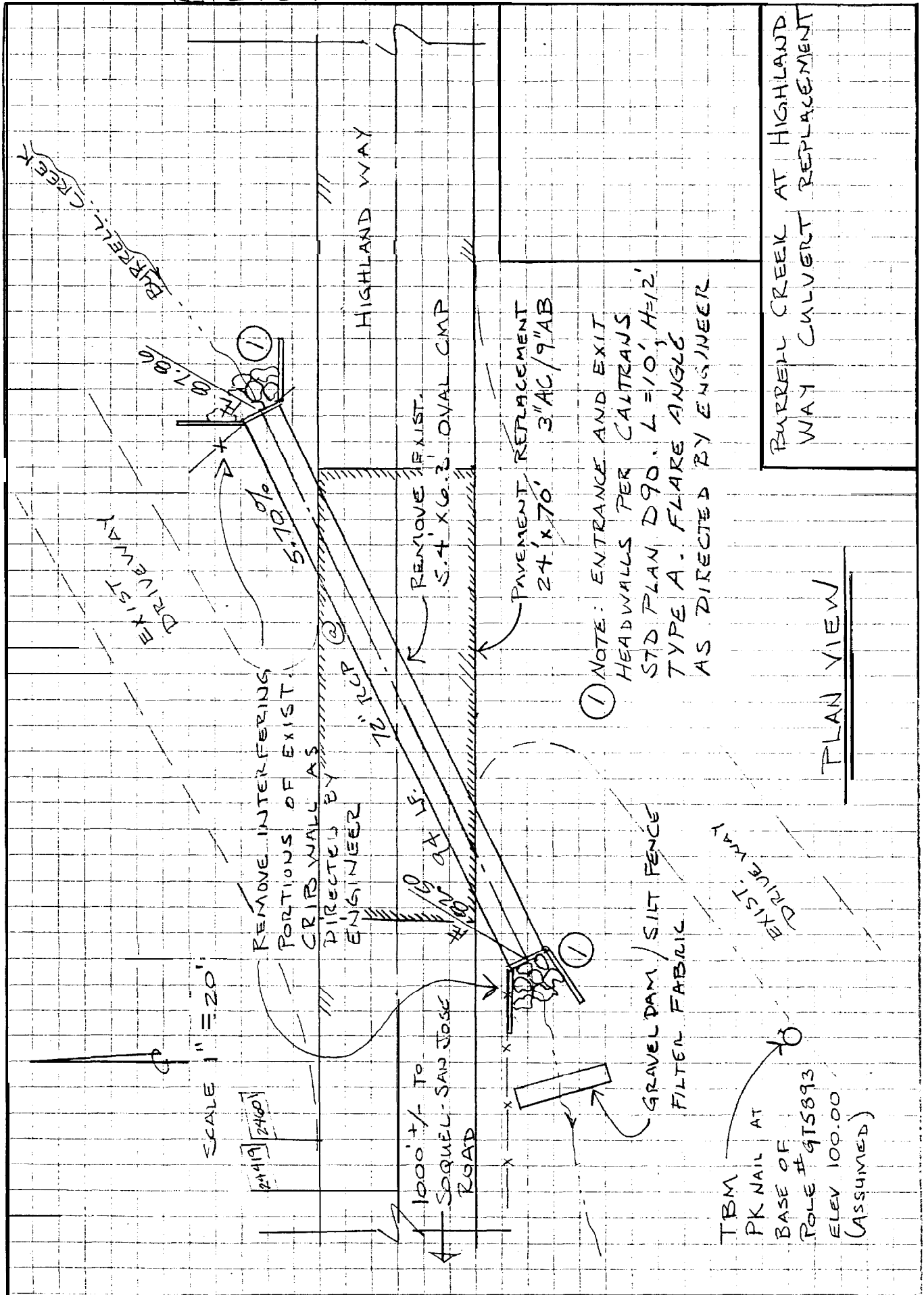

COUNTY OF SANTA CRUZ

DEPARTMENT OF PUBLIC WORKS

PROJECT **BURRELL CREEK**  
 LOCATION **HIGHLAND WAY**  
**CULVERT REPLACEMENT**

CALC BY **DJH** DATE **SEPT 1998** SHEET NO **2/**  
 CHECK BY DATE WORK ORDER NO **915**

