



County of Santa Cruz

PLANNING DEPARTMENT

701 OCEAN STREET, 4TH FLOOR, SANTA CRUZ, CA 95060
 (831) 454-2580 FAX: (831) 454-2131 TDD: (831) 454-2123

ALVIN D. JAMES, DIRECTOR

Agenda Date: March 9, 1999

February 18, 1999

Board of Supervisors
 County of Santa Cruz
 701 Ocean Street
 Santa Cruz, CA 95060

Subject: Schedule a public hearing to consider the proposal to rezone Assessor's Parcel Number: 064-211-72 from the Special Use (SU) zone district to the Timber Production (TP) zone district. Requires a Rezoning. The property is located on the east side of Empire Grade (4150 Empire Grade) at approximately 300 feet north of the intersection of Empire Grade and Smith Grade Roads.

Members of the Board:

On February 10, 1999, the Planning Commission considered Application 98-0665, a proposal to rezone the above-referenced parcel to Timber Production. The Planning Commission has recommended this application to your Board for consideration.

It is therefore, RECOMMENDED, that your Board schedule a public hearing to consider this application on Tuesday April 13, 1999, for the afternoon agenda starting at 1:30 p.m.

Sincerely,

Alvin D. James
 Planning Director

RECOMMENDED:

SUSAN A. MAURIELLO
 County Administrative Officer

cc: Gary Paul, 5521 Scotts Valley Drive Suite 235, Scotts Valley, CA 95066
 Tim Peet, 4150 Empire Grade, Santa Cruz, CA 95060

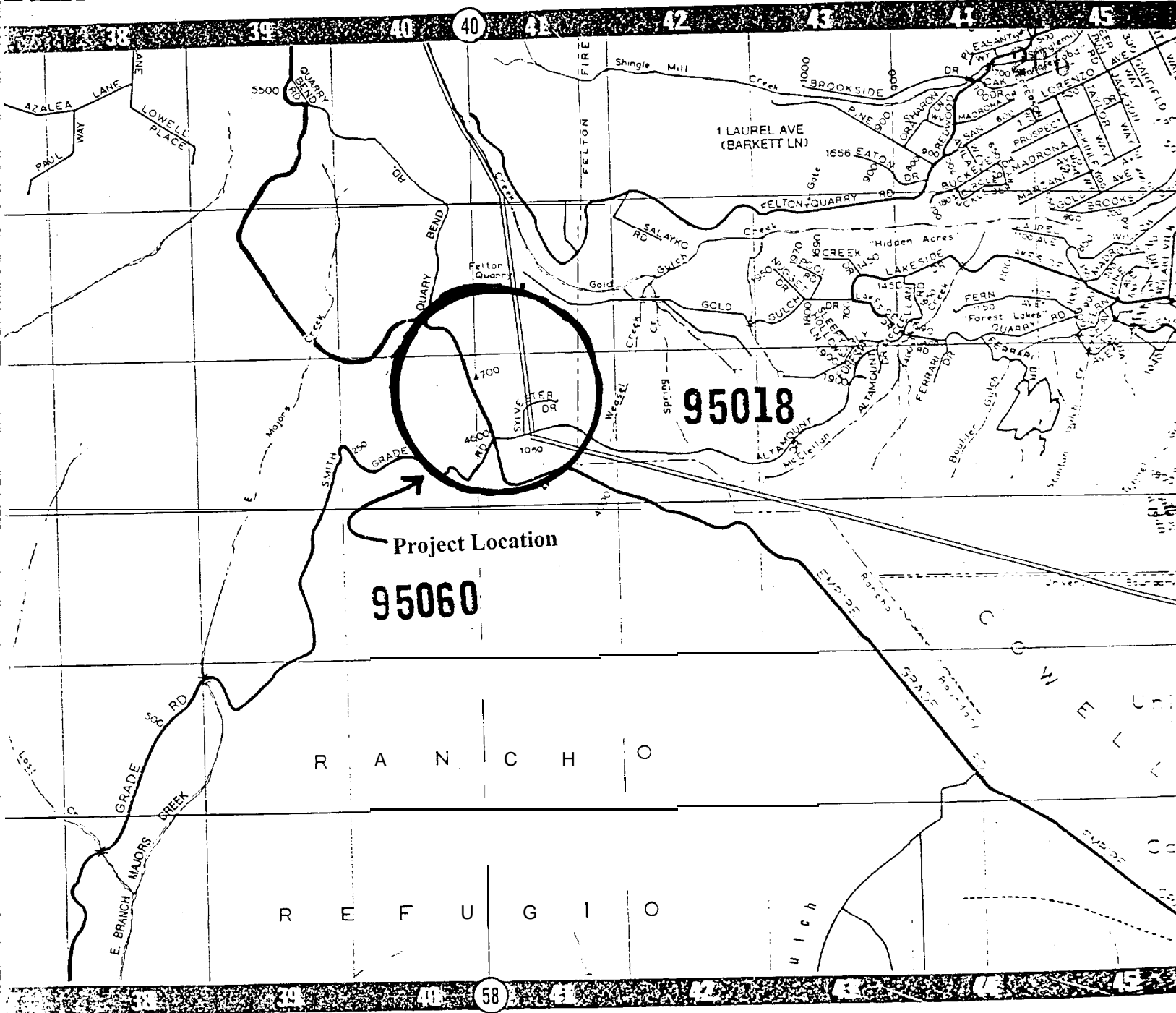

LOCATION MAP