



JOHN A. FANTHAM
DIRECTOR OF PUBLIC WORKS

County of Santa Cruz

036T
0489

DEPARTMENT OF PUBLIC WORKS

701 OCEAN STREET, ROOM 410, SANTA CRUZ, CA 95060
(831) 454-2160 FAX (831) 454-2385 TDD (831) 454-2123

AGENDA: JUNE 6, 2000

May 24, 2000

SANTA CRUZ COUNTY BOARD OF SUPERVISORS

701 Ocean Street
Santa Cruz, California 95060

SUBJECT: 4TH OF JULY ROAD CLOSURES, BEACH ACCESS

Members of the Board:

The Public Works Department was asked to help the California Highway Patrol (CHP), Santa Cruz County Sheriffs Office and the City of Santa Cruz Police Department with last year's 4th of July emergency road closures by providing barricades and detour signs. These road closures were necessary for traffic and crowd control. As a result, emergency vehicles were better able to access the roads adjacent to the beaches, and the huge traffic problems, experienced in prior years, were abated. Additionally, our local beaches had far fewer occurrences of illegal beach activities.

Public Works has again been asked to assist with the placement of road closure barricades and detour signs for this year's 4th of July. As with last year, access to the beaches for pedestrians will remain open and local authorities will assist with the closures to allow access to residents and emergency vehicles. The CHP and Sheriffs Office have agreed to advertise these closures. Public Works will also do a press release to the Santa Cruz Sentinel. Since this is expected to be an annual request, the emergency status of the closures should be reconsidered and done under a recommendation to your Board.

Attached is a listing of the County roads and maps with the detour positions that would take place on Tuesday, July 4, 2000, from 7:00 p.m. until approximately midnight.

SANTA CRUZ COUNTY BOARD OF SUPERVISORS

Page -2-

- 0 4 9 0

It is therefore recommended that the Board of Supervisors approve the road closures as shown on the attached list and direct the Public Works Department to provide and assist the CHP and Sheriff's Office with road closure barricades and detour signs.

Yours truly,

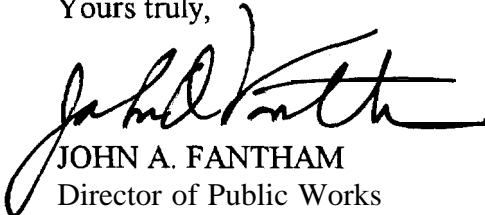

JOHN A. FANTHAM
Director of Public Works

RMA:mg

Attachments

RECOMMENDED FOR APPROVAL:

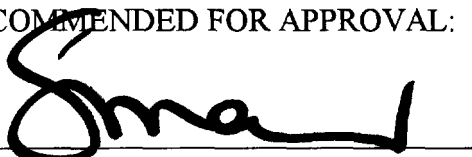

County Administrative Officer

copy to: Public Works
 California Highway Patrol (w/a)
 Sheriff Mark Tracy (w/a)
 City of Santa Cruz Police Department (w/a)
 City of Capitola Police Department (w/a)
 California Department of Forestry and Fire Protection (w/a)
 Central Fire Protection District (w/a)
 American Medical Response (w/a)
 Santa Cruz Metropolitan Transit District (w/a)
 Parks, Open Space and Cultural Services Department (w/a)
 California State Parks (w/a)
 Bill Dunlap, Road Superintendent (w/a)

FOURTH.DOC

FOURTH OF JULY ROAD CLOSURES, BEACH ACCESS

0363
0491

The following County roads will be affected by road closures and detours. Barricades and detour signs will be positioned at approximately 6:00 p.m. Closures and detours will begin at 7:00 p.m. and continue until approximately midnight.

1. 7th Avenue and Brommer Street - road closure barricades preventing southbound traffic on 7th Avenue, with an **officer** directing **traffic** eastbound onto Brommer Street.
2. 7th Avenue and **Capitola** Road - warning sign indicating "Road Closed Ahead" at 7th Avenue and Brommer Street.
3. 7th Avenue and Eaton Street - road closure barricades preventing southbound **traffic** on 7th Avenue, with an officer directing **traffic** northbound onto 7th Avenue.
4. Eaton Street and Lake Avenue - road closure barricades preventing southbound traffic on Lake Avenue, with an officer directing traffic eastbound toward 7th Avenue.
5. East Cliff Drive and Prospect Street - road closure barricades preventing access to 13th and 14th Avenues.
6. East Cliff Drive and 14th Avenue - road closure barricades preventing access to 13th and 14th Avenues.
7. East Cliff Drive and 14th Avenue - road closure barricades preventing access from Merrill Street.
8. 17th Avenue and Brommer Street - road closure barricades preventing southbound traffic on 17th Avenue, with an officer directing traffic both eastbound and westbound onto Brommer Street.
9. 17th Avenue and **Capitola** Road - warning sign indicating "Road Closed Ahead" at 17th Avenue and Brommer Street.
10. 17th Avenue and East Cliff Drive - road closure barricades preventing south and westbound traffic on East Cliff Drive, with an **officer** directing traffic onto eastbound Portola Drive.
11. Moosehead Drive and Marina Avenue - road closure barricades preventing southbound traffic to the Esplanade.
12. Rio Del Mar Boulevard and Club House Drive - with an officer directing traffic exiting area toward Highway 1, between 10 p.m. and midnight.
13. Spreckels Drive and Sea Cliff Drive - with an officer directing traffic exiting area toward Highway 1, between 10 p.m. and midnight.

0492

~~0364~~

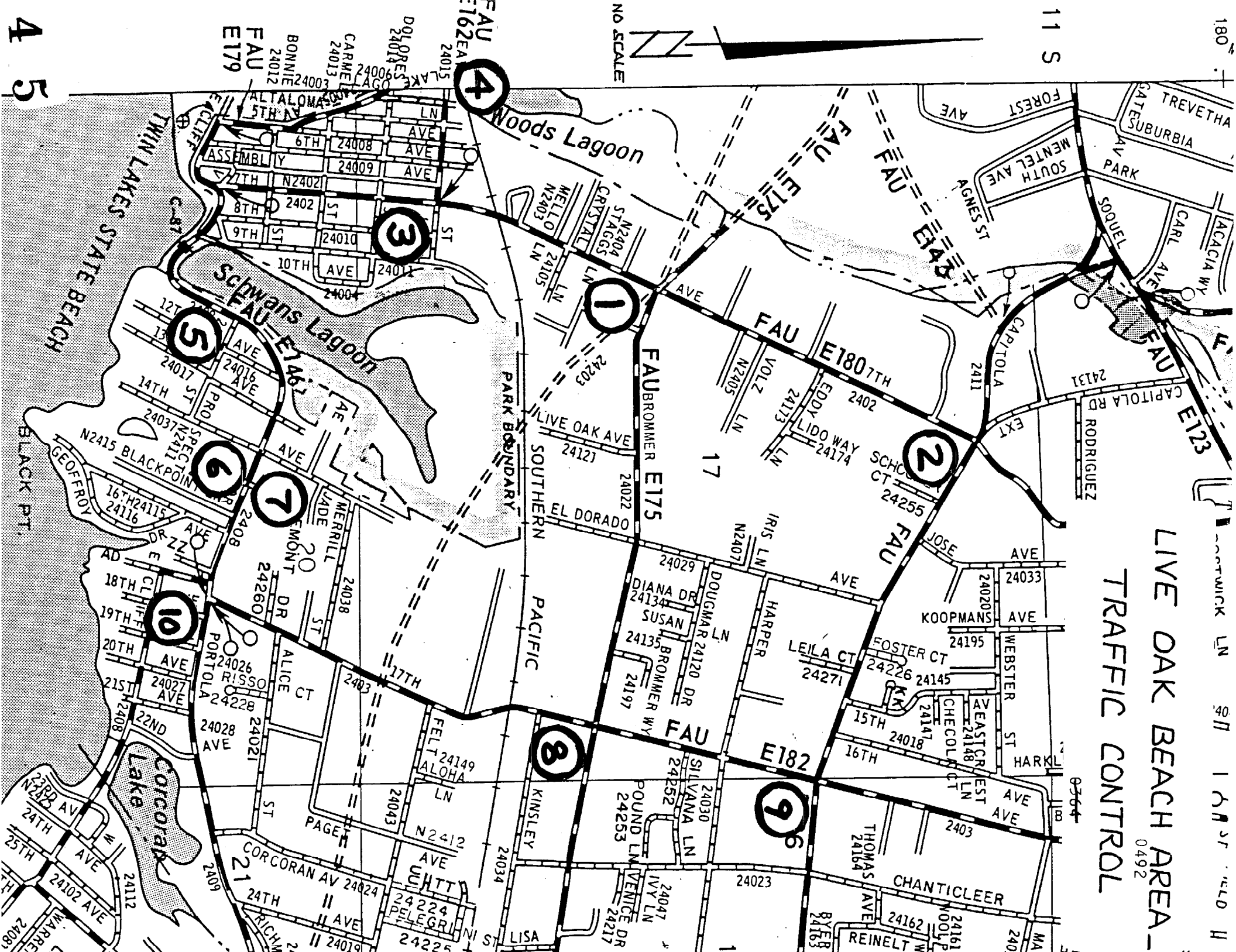

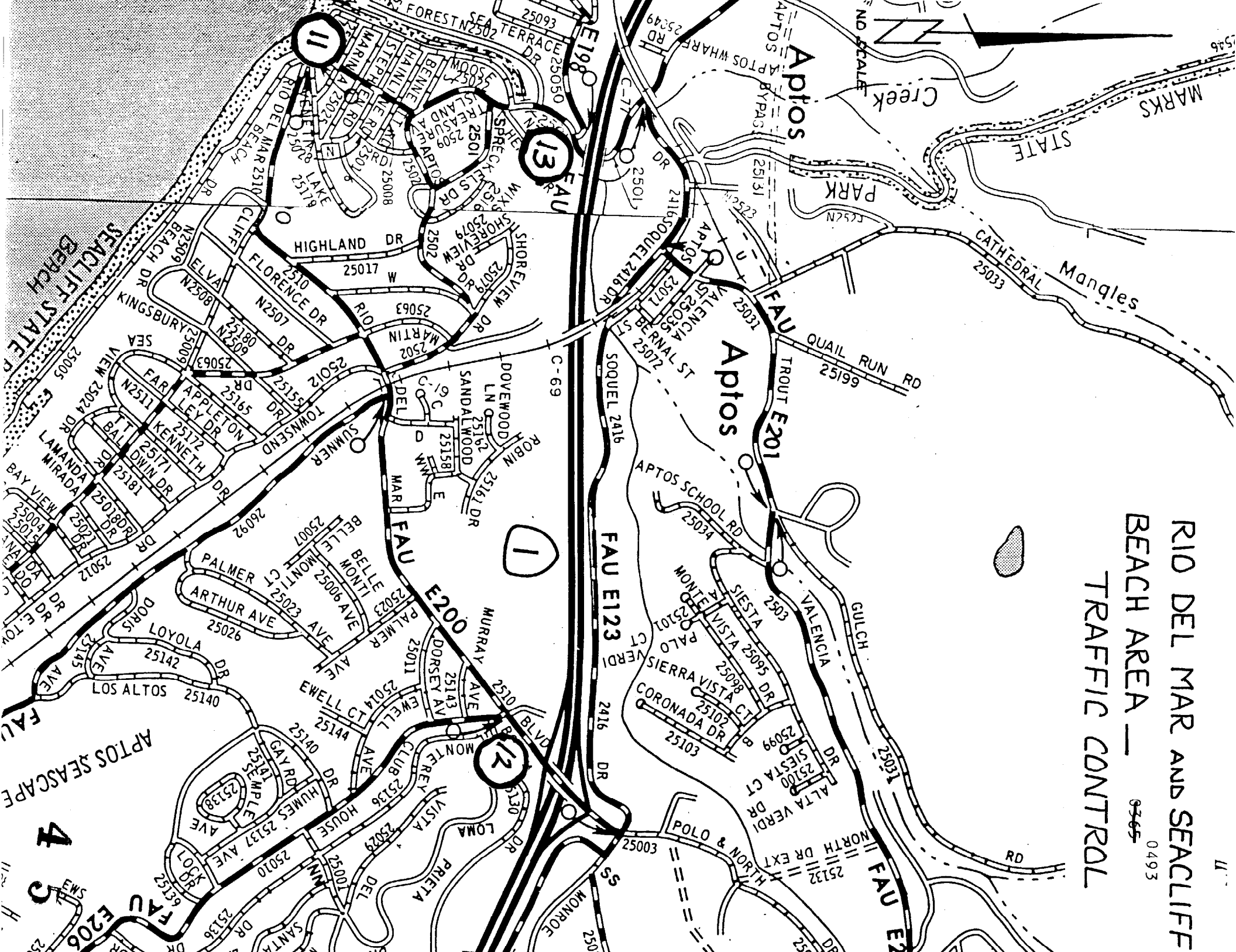

RIO DEL MAR AND SEACLIFF
BEACH AREA —
TRAFFIC CONTROL

0493