



County of Santa Cruz

DEPARTMENT OF PUBLIC WORKS

701 OCEAN STREET, ROOM 410, SANTA CRUZ, CA 950604070
(831) 454-2160 FAX (831) 454-2385 TDD (831) 454-2123

THOMAS L. BOLICH
DIRECTOR OF PUBLIC WORKS

AGENDA: MAY 1, 2001

April 19, 2001

SANTA CRUZ COUNTY BOARD OF SUPERVISORS

701 Ocean Street
Santa Cruz, California 95060

SUBJECT: MLD 98-0383 AND MLD 98-0384, ACCEPTANCE OF PESCE WAY
ALONG THE NORTH SIDE OF HARPER STREET IN LIVE OAK INTO
THE COUNTY MAINTAINED ROAD SYSTEM
DESIGNATION OF STOP INTERSECTION

Members of the Board:

On the September 23, 1999, the parcel map for MLD 98-0383 and MLD 980384 was recorded. The developer of the project completed construction of the required improvements on December 15, 2000. The Public Works Department inspected the constructed improvements and found that they are complete and acceptable.

In order for the County to assume maintenance responsibilities for Pesce Way, it will be necessary for your Board to formally accept dedications through MLD 98-0383, MLD 98-384 and adjacent property owners into the County Maintained Road System (see attached map and dedications).

Within the minor land division, it was determined that one stop sign was required as an improvement to regulate the intersection at Pesce Way and Harper Street. Attached is an ordinance to amend Chapter 9 of the Santa Cruz County Code to include the stop sign.

It is therefore recommended that the Board of Supervisors take the following action:

1. Adopt the attached resolution accepting Pesce Way along the north side of Harper Street in Live Oak into the County Maintained Road System.

2. Consider adoption in concept of ordinance amending Chapter 9.28 of the Santa Cruz County Code relating to designation of stop intersections.
- 3 Direct the Clerk of the Board to place the ordinance on the next available agenda for final adoption.

Yours truly,



THOMAS L. BOLICH
Director of Public Works

CRG:mg

Attachments

RECOMMENDED FOR APPROVAL:

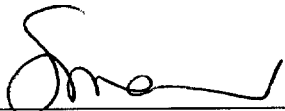

County Administrative Officer

copy to: Public Works

BEFORE THE BOARD OF SUPERVISORS
OF THE COUNTY OF SANTA CRUZ, STATE OF CALIFORNIA

0211

RESOLUTION NO. ____

On the motion of Supervisor
duly seconded by Supervisor
the following resolution is adopted:

RESOLUTION ACCEPTING PESCE WAY
ALONG THE NORTH SIDE OF HARPER STREET IN LIVE OAK
INTO THE COUNTY MAINTAINED ROAD SYSTEM

WHEREAS, Pesce Way has been constructed and improved to a suitable design standard; and

WHEREAS, the Director of Public Works recommends that said Pesce Way be accepted into the County Maintained Road System; and

WHEREAS, the Board of Supervisors finds, determines, and declares that the public convenience and necessity will be served if said Pesce Way dedications by Bedard and Davis hereinafter described is maintained as a part of the County Maintained Road System.

NOW, THEREFORE, BE IT RESOLVED AND ORDERED that all those portions of Pesce Way as shown upon that certain map entitled, Volume 56 of Parcel Maps, Page 23 and 24 and dedications Volume 22 PM, Page 20, Parcel "B" (Davis, Attachment I), and Volume 17 PM, Page 46, Parcel "C" (Bedard, Attachment II), is hereby accepted into the County Maintained Road System in accordance with Section 941 of the Streets and Highways Code.

PASSED AND ADOPTED by the Board of Supervisors of the County of Santa Cruz, State of California, this day of _____, 2001, by the following vote:

AYES: SUPERVISORS

NOES: SUPERVISORS

ABSENT: SUPERVISORS

Chairman of said Board

ATTEST: _____
Clerk of said Board

Approved as to form:



Chief Assistant County Counsel

Distribution: Assessor

Public Works
Survey

County Counsel
Recorder

Planning
Sheriff

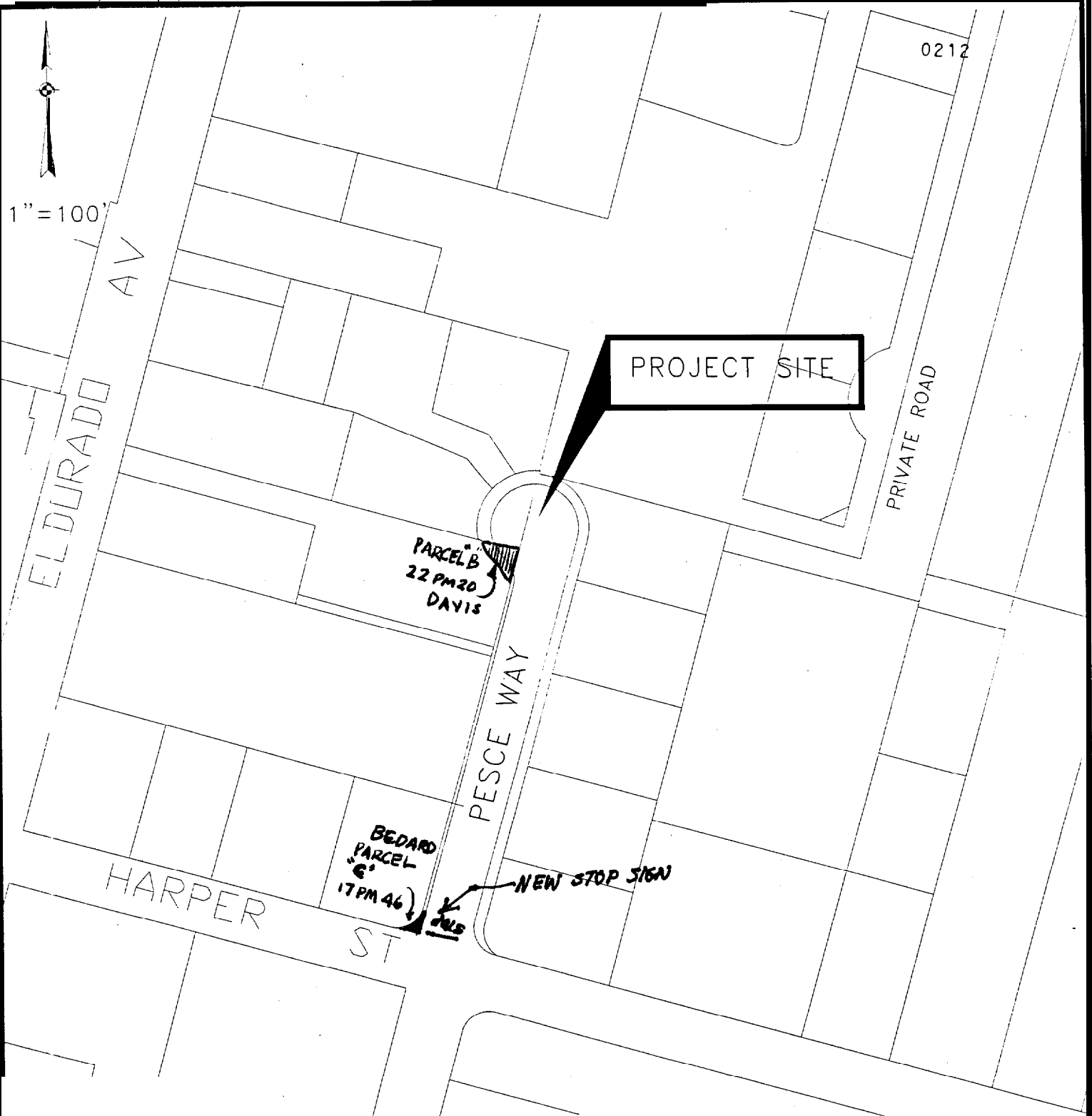

SANTA CRUZ COUNTY CONSTRUCTION DIVISION
ROAD ACCEPTANCE
PESCE WAY
MLD 98-0384 and 98-0383
APN: 26-067-Z THRU 11
JANUARY 2001
LOCATION MAP

38

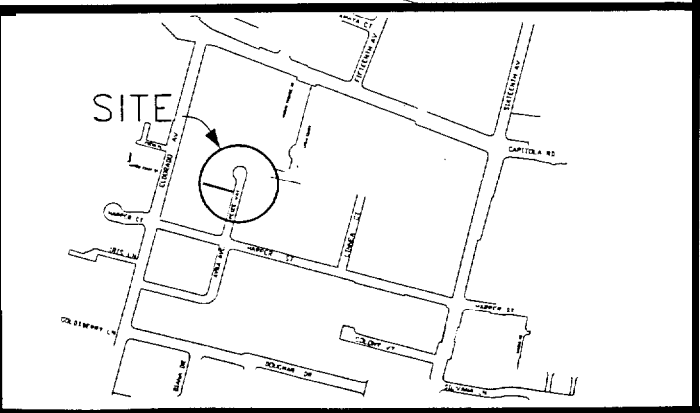



2000-0060797

RECORDED AT THE REQUEST OF:

COUNTY OF SANTA CRUZ

Govt. Agency Exempt

WHEN RECORDED RETURN TO:

COUNTY OF SANTA CRUZ

DEPT. OF PUBLIC WORKS

701 OCEAN STREET

SANTA CRUZ, CA 95060

Recorded
Official Records
County Of
SANTA CRUZ
RICHARD W. BEDAL
Recorder

RECORDED 3 .00

08:43AM 07-Dec-2000 | Page 1 of 2
BLS

ATTN: **Real** Property Division
PORTION APN: 026-531-01

OFFER OF DEDICATION

For value received Gail Melodie Davis, as Trustee of The Manuel J. Davis and Sylvia C. Davis
Revocable Living Trust under Agreement dated June '23, 1982

HEREBY makes an irrevocable offer to dedicate to the COUNTY OF SANTA CRUZ, a political
subdivision of the State of California, for the purposes of a public street
over the following described real
property situate in the County of Santa Cruz, **State** of California:

See attached Exhibit "A"

County of Santa Cruz Consents to the
recording of this document. This
does not constitute acceptance of
this offer.

By Scott Lee Cunge
Dated December 7, 2000

This offer of dedication is made pursuant to Section 7050 of the Government Code, and shall be binding
upon the heirs, successors, and assigns of the parties hereto.

STATE OF CALIFORNIA

County of Santa Cruz

On 12-5-00, 20 before me,
the undersigned, Notary Public, personally
appeared

Gail Melodie Davis, Trustee

personally known to me (or proved to me on the basis of satisfactory
evidence) to be the person(s) whose name(s) is/are subscribed to
the within instrument and acknowledged to me that he/she/they
executed the same in his/her/their authorized capacity(ies), and
that by his/her/their signature(s) on the instrument the person(s),
or the entity upon behalf of which the person(s) acted, executed the
instrument.

WITNESS my hand and official seal.

Signature [Signature]

Gail Melodie Davis, Trustee
Gail Melodie Davis, as Trustee

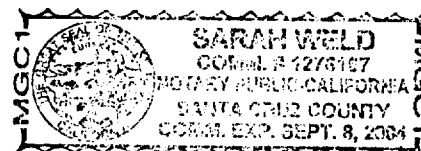

38



Offer of Dedication**Exhibit "A"**

A.P.N. 026-531-01

BEING a portion of Parcel "B" as shown upon that certain Parcel Map recorded in Volume 22 of Parcel Maps at Page 20, Records of Santa Cruz County and described as follows:

BEGINNING at the northeasterly corner of said Parcel "B"; thence along the easterly boundary, South 14° 50' 15" West 34.27 feet; thence leaving the last mentioned boundary on a curve to the left with a radius of 20.00 feet from a tangent bearing of North 14° 50' 15" East through an angle of 63° 15' 23" for a distance of 22.08 feet; thence on a curve to the right with a radius of 40.00 feet through an angle of 34° 44' 13" for a distance of 24.25 feet to a point on the northeasterly boundary of said Parcel "B" from which the point of beginning bears South 74° 44' 15" East 28.15 feet distant; thence along the last mentioned boundary, South 74° 44' 15" East 28.15 feet to the point of beginning.



2000-0060798

RECORDED AT THE REQUEST OF:
COUNTY OF SANTA CRUZ

Govt. Agency Exempt

WHEN RECORDED RETURN TO:

COUNTY OF SANTA CRUZ
DEPT. OF PUBLIC WORKS
701 OCEAN STREET
SANTA CRUZ, CA 95060

Recorded
Official Records
County Of
SANTA CRUZ
RICHARD W. BEDRL
Recorder

REC FEE .00

08:43AM 07-Dec-2000 | BLS
Page 1 of 2

ATTN: Real Property Division
PORTION APN: 026-531-07

OFFER OF DEDICATION

For value received Leo A. Bedard and Josephine E. Bedard, Co-Trustees of the Leo and Josephine Bedard Living Trust established July 29, 1994

HEREBY makes an **irrevocable** offer to dedicate to the COUNTY OF SANTA CRUZ, a political subdivision of the State of California, for the purposes of a public street over the following described real property situate in the County of Santa Cruz, State of California:

See attached Exhibit A

County of Santa Cruz Consents to the
recording of this document. This
does not constitute acceptance of
this offer.

By Leo A. Bedard
Dated December 7, 2000

This offer of dedication is made pursuant to Section 7050 of the Government Code, and shall be binding upon the heirs, successors, and assigns of the parties hereto.

STATE OF CALIFORNIA

County of Santa Cruz

On December 4, 2000, before me,
Mary Saccullo, Notary Public, personally
appeared Leo A. Bedard and
Josephine E. Bedard

personally known to me (or proved to me on the basis of satisfactory evidence) to be the person(s) whose name(s) is/are subscribed to the within instrument and acknowledged to me that he/she/they executed the same in his/her/their authorized capacity(ies), and that by his/her/their signature(s) on the instrument the person(s), or the entity upon behalf of which the person(s) acted, executed the instrument.

WITNESS my hand and official seal.

Signature Mary Saccullo



Leo A. Bedard
Leo A. Bedard, Trustee Trustee

Josephine E. Bedard, Trustee

Josephine E. Bedard Trustee



Offer of Dedication**Exhibit "A"**

A.P.N. 026-531-07

BEING a portion of Parcel "C" **as** shown upon that certain Parcel Map recorded in Volume 17 of parcel maps at page 46, Records of Santa Cruz County and described as follows:

BEGINNING at the southeasterly corner of said Parcel "C"; thence from said point of beginning along the easterly boundary of said parcel "C; North 14° 50' 15" East 20.16 feet; thence leaving the last mentioned boundary on a curve to the right with a radius of 20.00 feet from a tangent bearing of South 14° 50' 15" West through an angle of 90° 27' 00" for a distance of 31.57 feet to a point on the southeasterly boundary of said Parcel "C; from which the point of beginning bears South 74° 42' 45" East 20.16 feet distant; thence along the last mentioned boundary South 74° 42' 45" East 20.16 feet to the point of beginning.

ORDINANCE AMENDING CHAPTER 9 OF THE SANTA CRUZ COUNTY CODE
RELATING TO STOP INTERSECTIONS

The Board of Supervisors of the County of Santa Cruz does ordain as follows:

SECTION 1

Section 9.28.20 - Stop intersections designated, is hereby amended by adding paragraph P. 12.5 to read:

P. 12.5 On **Pesce Way, at Harper Street.**

SECTION 11

This Ordinance shall take effect on the 31st day **after** the date of final passage.

PASSED AND ADOPTED by the Board of Supervisors of the County of Santa Cruz, State of California, this _____ day of _____, 2001, by the following vote;

AYES: SUPERVISORS

NOES: SUPERVISORS

ABSENT: SUPERVISORS

Chairperson of said Board

ATTEST: _____
Clerk of said Board

Approved as to form:



Assistant County Counsel

Distribution: County Counsel
Public Works Department

ORDINANCE AMENDING CHAPTER 9 OF THE SANTA CRUZ COUNTY CODE
RELATING TO STOP INTERSECTIONS

The Board of Supervisors of the County of Santa Cruz does ordain as follows:

SECTION 1

Section 9.28.20 - Stop intersections designated, is hereby amended by adding paragraph P. 12.5 to read:

P.12.5 On Pesce Way, at Harper Street.

SECTION 11

This Ordinance shall take effect on the 31st day after the date of final passage.

PASSED AND ADOPTED by the Board of Supervisors of the County of Santa Cruz, State of California, this _____ day of _____, 2001, by the following vote;

AYES: SUPERVISORS

NOES: SUPERVISORS

ABSENT: SUPERVISORS

Chairperson of said Board

ATTEST: _____
Clerk of said Board

Approved as to form:



Assistant County Counsel

Distribution: County Counsel
Public Works Department