



THOMAS L. BOLICH  
DIRECTOR OF PUBLIC WORKS

# County of Santa Cruz

---

## DEPARTMENT OF PUBLIC WORKS

0355

701 OCEAN STREET, ROOM 410, SANTA CRUZ, CA 95060-4070  
(831) 454-2160 FAX (831) 454-2385 TDD (831) 454-2123

### AGENDA: APRIL 23, 2002

April 11, 2002

SANTA CRUZ COUNTY BOARD OF SUPERVISORS  
701 Ocean Street  
Santa Cruz CA. 95060

SUBJECT: SET PUBLIC HEARING TO CONSIDER ORDINANCE TO RESTRICT  
COMMERCIAL VEHICLE PARKING ON MC GLENN DRIVE

Members of the Board:

The registered voters of McGlenn Drive, from the intersection of Aster Lane to the end, have submitted a petition with a 59 percent approval rate along with the required fee to request the parking restriction of commercial vehicles on that segment of road (see attached map). The procedure outlined in County Code Section 9.70.600 requires that the Board of Supervisors hold a public hearing to consider the issue.

It is therefore recommended that the Board of Supervisors take the following action:

1. Adopt the attached resolution setting a public hearing date of May 7, 2002, to consider the attached ordinance to restrict commercial vehicle parking on McGlenn Drive.
2. Direct the Department of Public Works to post the attached public notice at least ten days in advance of the public hearing on McGlenn Drive.
3. Direct the Department of Public Works to send a notice by first class mail at least ten days in advance of the public hearing to each resident located on McGlenn Drive.

4. Direct the Clerk of the Board to publish a single display advertisement for the public hearing at least ten days in advance of the public hearing in the Santa Cruz Sentinel.

Yours truly,



THOMAS L. BOLICH  
Director of Public Works

HLP:bbs

Attachments

RECOMMENDED FOR APPROVAL:

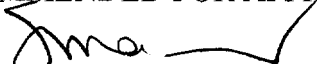

---

County Administrative Officer

Copy to:      Public Works Department

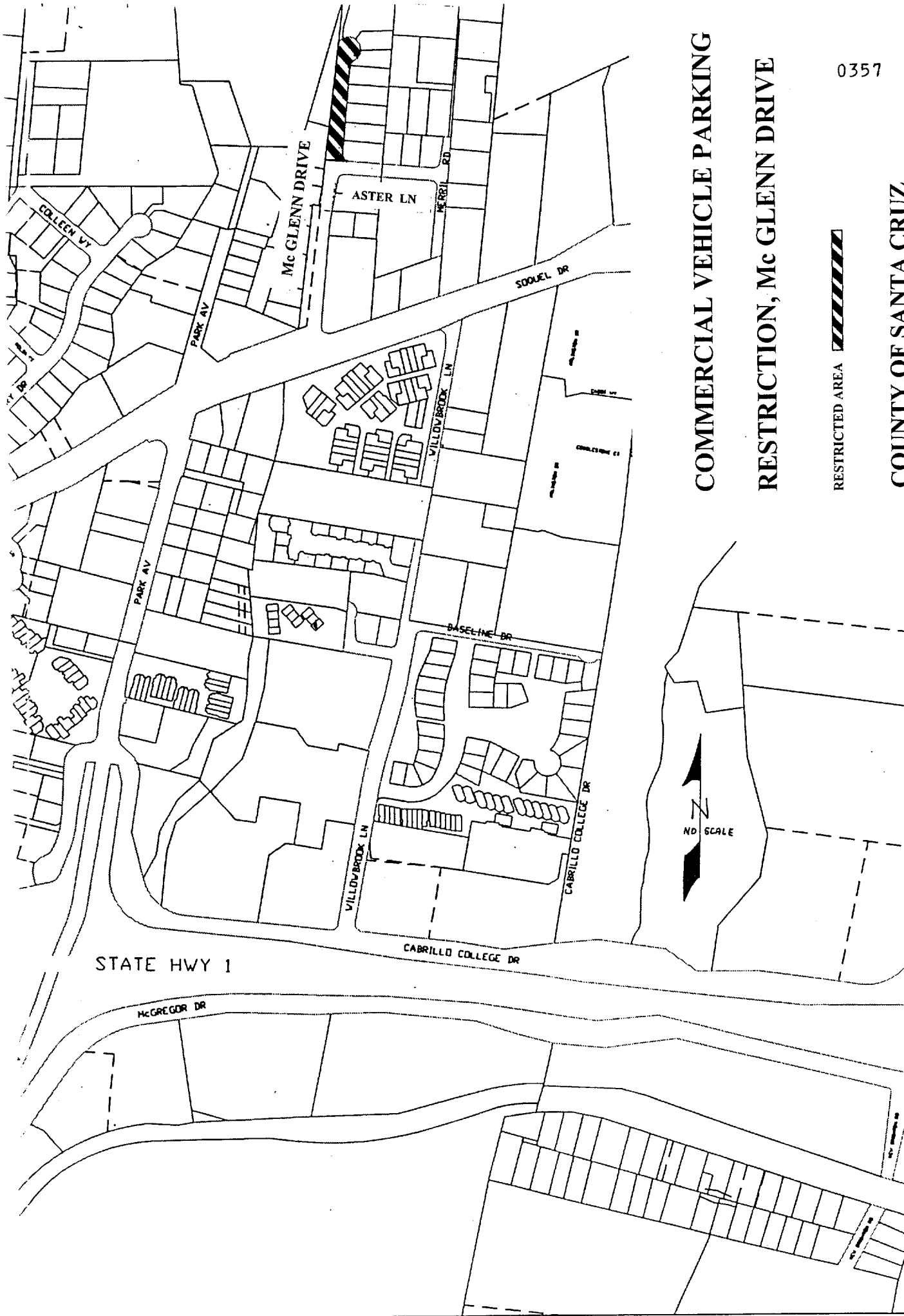

0357

COMMERCIAL VEHICLE PARKING

RESTRICTION, Mc GLENN DRIVE

RESTRICTED AREA

COUNTY OF SANTA CRUZ  
DEPARTMENT OF PUBLIC WORKS

APRIL 2002

# PUBLIC NOTICE

0358

A public hearing will be held in the Board of Supervisors Chambers at 701 Ocean Street on the morning of May 7, 2002, for the purpose of prohibiting the parking of commercial vehicles, pursuant to Section 9.70.600 of the County Code, on Mc Glenn Drive from Aster Lane to the end. Upon completion of the public hearing, the Board of Supervisors will consider approving an ordinance placing the restriction on Mc Glenn Drive.

Any questions or comments should be forwarded to the Traffic Operations Manager, Herb Parnell at (831) 454-2160.

**SANTA CRUZ COUNTY  
PUBLIC WORKS DEPARTMENT  
701 OCEAN STREET  
SANTA CRUZ, CA 95060  
(831) 454-2160**

BEFORE THE BOARD OF SUPERVISORS  
OF THE COUNTY OF SANTA CRUZ, STATE OF CALIFORNIA

RESOLUTION NO. \_\_\_\_\_

0359

On the motion of Supervisor  
duly seconded by Supervisor  
the following resolution is adopted:

RESOLUTION SETTING PUBLIC HEARING TO CONSIDER COMMERCIAL  
VEHICLE PARKING RESTRICTION ON MC GLENN DRIVE

WHEREAS, on Tuesday, May 7, 2002, during the morning agenda (which begins at 9:00 a.m.) in the Board Chambers, 701 Ocean Street, Room 525, Santa Cruz, California, the Board of Supervisors will conduct a public hearing on the proposed commercial vehicle parking restriction on McGlenn Drive.

NOW, THEREFORE, BE IT RESOLVED AND ORDERED that at the time, date, and place above, the Board of Supervisors of the County of Santa Cruz shall hear all objections or protests, if any, to the proposed parking restriction.

PASSED AND ADOPTED by the Board of Supervisors of the County of Santa Cruz, State of California, this \_\_\_\_ day of \_\_\_\_\_ 2002, by the following vote:

AYES: SUPERVISORS

NOES: SUPERVISORS

ABSENT: SUPERVISORS

\_\_\_\_\_  
Chairperson of said Board

ATTEST: \_\_\_\_\_  
Clerk of said Board

Approved as to form:

  
Assistant County Counsel

Distribution: County Counsel  
Public Works

ORDINANCE AMENDING CHAPTER 9 OF THE COUNTY CODE  
RELATING TO COMMERCIAL VEHICLE PARKING

## SECTION I

CHAPTER 9.70 STREETS AND ROADS is hereby amended by adding Section 9.70.601 to read:

9.70.601 Commercial Vehicle Parking Restrictions. The following streets or portions thereof, as indicated below are designated to be unlawful to park a commercial vehicle having a gross vehicle weight of ten thousand pounds or more, pursuant to Section 9.70.600 of this code:

1. McGlenn Drive, from Aster Lane to the end.

## SECTION II

This ordinance shall take effect on the 3 1st day after final passage.

PASSED AND ADOPTED by the Board of Supervisors of the County of Santa Cruz, State of California, this \_\_\_\_ day of \_\_\_\_\_, 2002, by the following vote:

YES: SUPERVISORS  
NOES: SUPERVISORS  
ABSENT: SUPERVISORS

\_\_\_\_\_  
Chairperson of said Board

ATTEST: \_\_\_\_\_  
Clerk of said Board

Approved as to form:

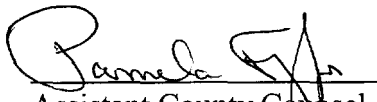
  
Assistant County Counsel

Distribution: County Counsel  
Public Works