



COUNTY OF SANTA CRUZ

PLANNING DEPARTMENT

701 OCEAN STREET, 4TH FLOOR, SANTA CRUZ, CA 95060
(831) 454-2580 FAX: (831) 454-2131 TDD: (831) 454-2123

KATHY MOLLOY PREVISICH, PLANNING DIRECTOR

ENVIRONMENTAL COORDINATOR

NOTICE OF INTENT TO ADOPT A PROPOSED NEGATIVE DECLARATION

Pursuant to the California Environmental Quality Act, the following projects have been reviewed by the County Environmental Coordinator to determine if they have a potential to create significant impacts to the environment and, if so, how such impacts could be solved. A negative declaration has been prepared in cases where the project is determined not to have any significant environmental impacts. An environmental impact report (EIR) will be prepared for projects, which could have a significant impact.

Public review periods are provided for these environmental documents according to the requirements of the County Environmental Review Guidelines, depending upon whether State agency review is required or whether an EIR is required. The environmental documents are available for review at the County Planning Department at 701 Ocean Street, Santa Cruz. You may also view environmental documents on the web at www.sccoplanning.com under the Planning Department menu, Agendas link. If you have questions or comments about these determinations please contact Matt Johnston of the Environmental Review staff at (831) 454-3201

The County of Santa Cruz does not discriminate on the basis of disability, and no person shall, by reason of a disability, be denied the benefits of its services, programs or activities. If you require special assistance in order to review this information, please contact Bernice Romero at (831) 454-3137 (TDD number (831) 454-2123 or (831) 763-8123) to make arrangements.

09-0052 2500 GLENWOOD DRIVE, SCOTTS VALLEY

APN(S): N/A

Proposal to repair a slip out and to fill approximately 17 cubic yards of material adjacent to Bean Creek. Requires a Riparian Exception and Environmental Review. Project located within the right-of-way for Glenwood Drive. The project area is in the vicinity of 2500 Glenwood Drive and post mile marker 1.36.

ZONE DISTRICT: RA - Residential Agriculture

APPLICANT/OWNER: County of Santa Cruz

STAFF PLANNER: Bob Loveland, 454-3163

EMAIL: pln319@co.santa-cruz.ca.us

ACTION: Negative Declaration with mitigations

REVIEW PERIOD: JUNE 7, 2011 – JULY 7, 2011

This project will be administratively considered by the project planner. The time, date and location have not been set. When scheduling does occur, these items will be included in all public hearing notices for the project.

NAME: Glenwood Road 1.36
APPLICATION: 09-0052
A.P.N: County Right of Way

NEGATIVE DECLARATION MITIGATIONS

- A. In order to ensure that mitigation measures B through D are communicated to the crewmembers responsible for constructing the project and are properly implemented, the Department of Public Works (DPW) shall organize a pre-construction meeting on the site to review the mitigation measures. The following parties shall attend: DPW project engineer, project crew supervisor, project biologists and Environmental Planning staff. The disturbance envelope will be verified, sediment barrier plan will be inspected, and the results of pre-construction wildlife surveys will be collected at that time.
- B. In order to prevent adverse impacts to California red legged frogs (*Rana aurora draytonii*) (CLRF) and Western pond turtle (*Clemmys marmorata*), a qualified wildlife biologist shall perform pre-construction surveys and conduct an educational session with all work crewmembers prior to disturbance. All vegetation removal and disturbance shall only occur in the presence of a qualified biological resource monitor. If CLRF are identified in the work area during the project or the preconstruction surveys the monitor shall halt activity and contact the U.S. Fish and Wildlife Service for direction and recommendations to avoid take of the species
 - a. Due to the proximity to known California red-legged frog observations, daily monitoring during construction shall be conducted by the biological monitor to document that construction activities are not causing habitat degradation and/or excessive adverse water quality conditions.
- C. In order to prevent erosion and sedimentation of the creek, prior to disturbance DPW shall implement an erosion control plan to be reviewed and approved by Environmental Planning staff at the pre-construction meeting. Environmental Planning staff shall confirm that access to the work area is from the top of the bank and construction will be accomplished per the erosion control plan, that if dewatering of the keyway trench portion of the stream channel is necessary all provisions are in place to address sediment, that the spoils storage area is away from the creek bank and protected from erosion, and shall confirm the silt fencing and other erosion control features are properly installed.
- D. In order to prevent adverse impacts to salmonids and water quality, disturbance shall be allowed only during the dry season between June 1 and October 15. This time period may be extended until November 15th at the discretion of the Planning Department and with no precipitation forecast in the near future.



County of Santa Cruz

PLANNING DEPARTMENT

701 OCEAN STREET, 4TH FLOOR, SANTA CRUZ, CA 95060
(831) 454-2580 FAX: (831) 454-2131 TDD: (831) 454-2123
KATHLEEN MOLLOY PREVISICH, PLANNING DIRECTOR
www.sccoplanning.com

CALIFORNIA ENVIRONMENTAL QUALITY ACT (CEQA) ENVIRONMENTAL REVIEW INITIAL STUDY

Date: May 26, 2011

Application Number: 09-0052

Staff Planner: Bob Loveland

I. OVERVIEW AND ENVIRONMENTAL DETERMINATION

APPLICANT: County of Santa Cruz
(Department of Public Works)

APN(s): No APN (County right-of-way on
Glenwood Drive (Post Mile Marker 1.36))

CONTACT: Jesse Brister
(831) 454-3316

SUPERVISORAL DISTRICT: Mark Stone
(Fifth District)

PROJECT LOCATION:

The project area is in the vicinity of 2500 Glenwood Drive and Post Mile Marker 1.36 in Santa Cruz County.

SUMMARY PROJECT DESCRIPTION:

Proposal to repair a slip out and to fill approximately 17 cubic yards of material adjacent to Bean Creek. Requires a Riparian Exception and Environmental Review. Project located within the right-of-way for Glenwood Drive at post mile marker 1.36.

ENVIRONMENTAL FACTORS POTENTIALLY AFFECTED: All of the following potential environmental impacts are evaluated in this Initial Study. Categories that are marked have been analyzed in greater detail based on project specific information.

- | | |
|---|---|
| <input type="checkbox"/> Geology/Soils | <input type="checkbox"/> Noise |
| <input type="checkbox"/> Hydrology/Water Supply/Water Quality | <input type="checkbox"/> Air Quality |
| <input checked="" type="checkbox"/> Biological Resources | <input type="checkbox"/> Greenhouse Gas Emissions |
| <input type="checkbox"/> Agriculture and Forestry Resources | <input type="checkbox"/> Public Services |
| <input type="checkbox"/> Mineral Resources | <input type="checkbox"/> Recreation |
| <input type="checkbox"/> Visual Resources & Aesthetics | <input type="checkbox"/> Utilities & Service Systems |
| <input type="checkbox"/> Cultural Resources | <input type="checkbox"/> Land Use and Planning |
| <input type="checkbox"/> Hazards & Hazardous Materials | <input type="checkbox"/> Population and Housing |
| <input type="checkbox"/> Transportation/Traffic | <input type="checkbox"/> Mandatory Findings of Significance |

DISCRETIONARY APPROVAL(S) BEING CONSIDERED:

- | | |
|---|--|
| <input type="checkbox"/> General Plan Amendment | <input type="checkbox"/> Coastal Development Permit |
| <input type="checkbox"/> Land Division | <input type="checkbox"/> Grading Permit |
| <input type="checkbox"/> Rezoning | <input checked="" type="checkbox"/> Riparian Exception |
| <input type="checkbox"/> Development Permit | <input type="checkbox"/> Other: |

NON-LOCAL APPROVALS

Other agencies that must issue permits or authorizations:

DETERMINATION: (To be completed by the lead agency)

On the basis of this initial evaluation:

- ☐ I find that the proposed project COULD NOT have a significant effect on the environment, and a NEGATIVE DECLARATION will be prepared.
- ☒ I find that although the proposed project could have a significant effect on the environment, there will not be a significant effect in this case because revisions in the project have been made or agreed to by the project proponent. A MITIGATED NEGATIVE DECLARATION will be prepared.
- ☐ I find that the proposed project MAY have a significant effect on the environment, and an ENVIRONMENTAL IMPACT REPORT is required.
- ☐ I find that the proposed project MAY have a "potentially significant impact" or "potentially significant unless mitigated" impact on the environment, but at least one effect 1) has been adequately analyzed in an earlier document pursuant to applicable legal standards, and 2) has been addressed by mitigation measures based on the earlier analysis as described on attached sheets. An ENVIRONMENTAL IMPACT REPORT is required, but it must analyze only the effects that remain to be addressed.
- ☐ I find that although the proposed project could have a significant effect on the environment, because all potentially significant effects (a) have been analyzed adequately in an earlier EIR or NEGATIVE DECLARATION pursuant to applicable standards, and (b) have been avoided or mitigated pursuant to that earlier EIR or NEGATIVE DECLARATION, including revisions or mitigation measures that are imposed upon the proposed project, nothing further is required.

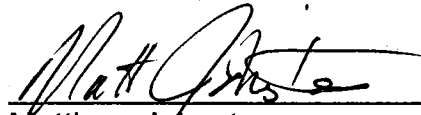
Matthew Johnston
Environmental Coordinator

5/26/11
Date

II. BACKGROUND INFORMATION

EXISTING SITE CONDITIONS

Parcel Size: NA

Existing Land Use: County maintained road adjacent to an established riparian corridor.

Vegetation: Mixed hardwood and conifer forests

Slope in area affected by project: ☐ 0 - 30% ☒ 31 - 100%

Nearby Watercourse: Bean Creek

Distance To: Approximately 10 feet

ENVIRONMENTAL RESOURCES AND CONSTRAINTS

Water Supply Watershed: Yes

Groundwater Recharge: No

Timber or Mineral: Yes-Portion

Agricultural Resource: NA

Biologically Sensitive Habitat: Yes

Fire Hazard: No

Floodplain: No

Erosion: Yes

Landslide: Yes

Liquefaction: No

Fault Zone: No

Scenic Corridor: No

Historic: No

Archaeology: No

Noise Constraint: No

Electric Power Lines: Yes

Solar Access: NA

Solar Orientation: NA

Hazardous Materials: No

Other:

SERVICES

Fire Protection: Scotts Valley Fire District

School District: NA

Sewage Disposal: NA

Drainage District: Zone 0

Project Access: Mile Marker 1.36

Water Supply: Wells

PLANNING POLICIES

Zone District: Residential Agriculture

General Plan: Mountain Residential

Urban Services Line: ☐ Inside

Coastal Zone: ☐ Inside

Special Designation: NA

☒ Outside

☒ Outside

ENVIRONMENTAL SETTING AND SURROUNDING LAND USES:

The project area consists of the failed roadway embankment above a freshwater stream habitat and within the road impinged riparian zone. The land use in the project vicinity is rural residential and timber harvest preserve.

PROJECT BACKGROUND:

During the September-October 2006 storm season high storm water flows in Bean Creek washed out a section of stream bank causing the roadway edge to collapse into the creek. The County of Santa Cruz requested public assistance to reconstruct the failed roadway through the Federal Emergency Management Agency (FEMA) and was approved (FEMA CA DR1646).

A biotic assessment has been completed by Kittleson Consulting (March 31, 2008).

DETAILED PROJECT DESCRIPTION:

The repair work involved in reestablishing and stabilizing this section of county maintained roadway includes: placement of 17 cubic yards of compacted fill and associated erosion control practices to aid in stabilizing fill.

The slipout area is approximately 10 feet in length, 3 feet in width and 15 feet in depth. The project proposed, will not require any work within the low-flow channel and no stream diversion is required. Installation and removal of silt and plywood debris fencing may result in minor temporal disturbance and turbidity, but this is not expected to change the chemistry of the waterway.

Potentially Significant Impact	Less than Significant with Mitigation Incorporated	Less than Significant Impact	No Impact
--------------------------------------	--	------------------------------------	-----------

III. ENVIRONMENTAL REVIEW CHECKLIST

A. GEOLOGY AND SOILS

Would the project:

1. Expose people or structures to potential substantial adverse effects, including the risk of loss, injury, or death involving:
 - A. Rupture of a known earthquake fault, as delineated on the most recent Alquist-Priolo Earthquake Fault Zoning Map issued by the State Geologist for the area or based on other substantial evidence of a known fault? Refer to Division of Mines and Geology Special Publication 42.
 - B. Strong seismic ground shaking?
 - C. Seismic-related ground failure, including liquefaction?
 - D. Landslides?

<input type="checkbox"/>	<input type="checkbox"/>	<input checked="" type="checkbox"/>	<input type="checkbox"/>
<input type="checkbox"/>	<input type="checkbox"/>	<input checked="" type="checkbox"/>	<input type="checkbox"/>
<input type="checkbox"/>	<input type="checkbox"/>	<input checked="" type="checkbox"/>	<input type="checkbox"/>
<input type="checkbox"/>	<input type="checkbox"/>	<input checked="" type="checkbox"/>	<input type="checkbox"/>

Discussion (A through D): The project site is located outside of the limits of the State Alquist-Priolo Special Studies Zone (County of Santa Cruz GIS Mapping, California Division of Mines and Geology, 2001). However, large earthquakes can be expected in the future. The October 17, 1989 Loma Prieta earthquake (magnitude 7.1) was the second largest earthquake in central California history.

All of Santa Cruz County is subject to some hazard from earthquakes. However, the project site is not located within or adjacent to a County or state mapped fault zone, therefore the potential for ground surface rupture is low. The project site is likely to be subject to strong seismic shaking during the life of the improvements. There is no indication that landsliding is a significant hazard at this site.

- | | Potentially
Significant
Impact | Less than
Significant
with
Mitigation
Incorporated | Less than
Significant
Impact | No Impact |
|---|--------------------------------------|--|-------------------------------------|--------------------------|
| 2. Be located on a geologic unit or soil that is unstable, or that would become unstable as a result of the project, and potentially result in on- or off-site landslide, lateral spreading, subsidence, liquefaction, or collapse? | <input type="checkbox"/> | <input type="checkbox"/> | <input checked="" type="checkbox"/> | <input type="checkbox"/> |

Discussion: Following a review of mapped information and a field visit to the site, there is no indication that the development site is subject to a significant potential for damage caused by any of these hazards.

- | | | | | |
|---|--------------------------|--------------------------|-------------------------------------|--------------------------|
| 3. Develop land with a slope exceeding 30%? | <input type="checkbox"/> | <input type="checkbox"/> | <input checked="" type="checkbox"/> | <input type="checkbox"/> |
|---|--------------------------|--------------------------|-------------------------------------|--------------------------|

Discussion: The project slope is in excess of 30%. In order to repair and stabilize the damaged slope the fill slope must be constructed on slopes exceeding 30%.

- | | | | | |
|---|--------------------------|--------------------------|-------------------------------------|--------------------------|
| 4. Result in substantial soil erosion or the loss of topsoil? | <input type="checkbox"/> | <input type="checkbox"/> | <input checked="" type="checkbox"/> | <input type="checkbox"/> |
|---|--------------------------|--------------------------|-------------------------------------|--------------------------|

Discussion: The potential for erosion exists during the construction phase of the project and shortly thereafter. Appropriate erosion and sediment control Best Management Practices (BMP's) will be installed and monitored during and after construction activities are completed.

- | | | | | |
|---|--------------------------|--------------------------|-------------------------------------|--------------------------|
| 5. Be located on expansive soil, as defined in Section 1802.3.2 of the California Building Code (2007), creating substantial risks to life or property? | <input type="checkbox"/> | <input type="checkbox"/> | <input checked="" type="checkbox"/> | <input type="checkbox"/> |
|---|--------------------------|--------------------------|-------------------------------------|--------------------------|

Discussion: There is no indication that the development site is subject to substantial risk caused by expansive soils.

- | | | | | |
|--|--------------------------|--------------------------|--------------------------|-------------------------------------|
| 6. Place sewage disposal systems in areas dependent upon soils incapable of adequately supporting the use of septic tanks, leach fields, or alternative waste water disposal systems where sewers are not available? | <input type="checkbox"/> | <input type="checkbox"/> | <input type="checkbox"/> | <input checked="" type="checkbox"/> |
|--|--------------------------|--------------------------|--------------------------|-------------------------------------|

Discussion: No septic systems are proposed.

	Potentially Significant Impact	Less than Significant with Mitigation Incorporated	Less than Significant Impact	No Impact
7. Result in coastal cliff erosion?	<input type="checkbox"/>	<input type="checkbox"/>	<input type="checkbox"/>	<input checked="" type="checkbox"/>

Discussion: The proposed project is not located in the vicinity of a coastal cliff or bluff; and therefore, would not contribute to coastal cliff erosion.

B. HYDROLOGY, WATER SUPPLY, AND WATER QUALITY

Would the project:

1. Place development within a 100-year flood hazard area as mapped on a federal Flood Hazard Boundary or Flood Insurance Rate Map or other flood hazard delineation map?	<input type="checkbox"/>	<input type="checkbox"/>	<input checked="" type="checkbox"/>	<input type="checkbox"/>
--	--------------------------	--------------------------	-------------------------------------	--------------------------

Discussion: According to the Federal Emergency Management Agency (FEMA) National Flood Insurance Rate Map, dated March 2, 2006, no portion of the project site lies within a 100-year flood hazard area.

2. Place within a 100-year flood hazard area structures which would impede or redirect flood flows?	<input type="checkbox"/>	<input type="checkbox"/>	<input checked="" type="checkbox"/>	<input type="checkbox"/>
---	--------------------------	--------------------------	-------------------------------------	--------------------------

Discussion: According to the Federal Emergency Management Agency (FEMA) National Flood Insurance Rate Map, dated March 2, 2006, no portion of the project site lies within a 100-year flood hazard area.

3. Be inundated by a seiche, tsunami, or mudflow?	<input type="checkbox"/>	<input type="checkbox"/>	<input type="checkbox"/>	<input checked="" type="checkbox"/>
---	--------------------------	--------------------------	--------------------------	-------------------------------------

Discussion: The project site is over 5 miles inland from the ocean.

4. Substantially deplete groundwater supplies or interfere substantially with groundwater recharge such that there would be a net deficit in aquifer volume or a lowering of the local groundwater table level (e.g., the production rate of pre-existing nearby wells would drop to a level which would not support existing land uses or planned uses for which permits have been granted)?	<input type="checkbox"/>	<input type="checkbox"/>	<input type="checkbox"/>	<input checked="" type="checkbox"/>
---	--------------------------	--------------------------	--------------------------	-------------------------------------

Discussion: The project is not located in a mapped groundwater recharge area.

- | | Potentially
Significant
Impact | Less than
Significant
with
Mitigation
Incorporated | Less than
Significant
Impact | No Impact |
|---|--------------------------------------|--|-------------------------------------|--------------------------|
| 5. Substantially degrade a public or private water supply? (Including the contribution of urban contaminants, nutrient enrichments, or other agricultural chemicals or seawater intrusion). | <input type="checkbox"/> | <input type="checkbox"/> | <input checked="" type="checkbox"/> | <input type="checkbox"/> |

Discussion: Construction equipment shall be maintained in proper operating condition to prevent leaks of oil and/or grease.

- | | | | | |
|---------------------------------------|--------------------------|--------------------------|--------------------------|-------------------------------------|
| 6. Degrade septic system functioning? | <input type="checkbox"/> | <input type="checkbox"/> | <input type="checkbox"/> | <input checked="" type="checkbox"/> |
|---------------------------------------|--------------------------|--------------------------|--------------------------|-------------------------------------|

Discussion: There is no septic system currently in the proposed project area, and no new septic system is proposed.

- | | | | | |
|--|--------------------------|--------------------------|-------------------------------------|--------------------------|
| 7. Substantially alter the existing drainage pattern of the site or area, including through the alteration of the course of a stream or river, or substantially increase the rate or amount of surface runoff in a manner which would result in flooding, on- or off-site? | <input type="checkbox"/> | <input type="checkbox"/> | <input checked="" type="checkbox"/> | <input type="checkbox"/> |
|--|--------------------------|--------------------------|-------------------------------------|--------------------------|

Discussion: No stream diversion or wetland fill is proposed.

- | | | | | |
|---|--------------------------|--------------------------|-------------------------------------|--------------------------|
| 8. Create or contribute runoff water which would exceed the capacity of existing or planned storm water drainage systems, or provide substantial additional sources of polluted runoff? | <input type="checkbox"/> | <input type="checkbox"/> | <input checked="" type="checkbox"/> | <input type="checkbox"/> |
|---|--------------------------|--------------------------|-------------------------------------|--------------------------|

Discussion: No newly collected runoff is proposed as part of this project.

- | | | | | |
|--|--------------------------|--------------------------|-------------------------------------|--------------------------|
| 9. Expose people or structures to a significant risk of loss, injury or death involving flooding, including flooding as a result of the failure of a levee or dam? | <input type="checkbox"/> | <input type="checkbox"/> | <input checked="" type="checkbox"/> | <input type="checkbox"/> |
|--|--------------------------|--------------------------|-------------------------------------|--------------------------|

Discussion: The stream geometry will not be altered. The general pattern and flow of the stream would not change.

- | | | | | |
|--|--------------------------|--------------------------|-------------------------------------|--------------------------|
| 10. Otherwise substantially degrade water quality? | <input type="checkbox"/> | <input type="checkbox"/> | <input checked="" type="checkbox"/> | <input type="checkbox"/> |
|--|--------------------------|--------------------------|-------------------------------------|--------------------------|

Discussion: All work will be completed from the roadside. No temporary water diversion will be required as part of the project.

Potentially Significant Impact	Less than Significant with Mitigation Incorporated	Less than Significant Impact	No Impact
--------------------------------------	--	------------------------------------	-----------

C. BIOLOGICAL RESOURCES

Would the project:

- | | | | | | |
|----|--|--------------------------|-------------------------------------|--------------------------|--------------------------|
| 1. | Have a substantial adverse effect, either directly or through habitat modifications, on any species identified as a candidate, sensitive, or special status species in local or regional plans, policies, or regulations, or by the California Department of Fish and Game, or U.S. Fish and Wildlife Service? | <input type="checkbox"/> | <input checked="" type="checkbox"/> | <input type="checkbox"/> | <input type="checkbox"/> |
|----|--|--------------------------|-------------------------------------|--------------------------|--------------------------|

Discussion: A Biotic Assessment was prepared for this project by Kittleson Environmental Consulting, dated March 31, 2008 (Attachment 3). This report has been reviewed and accepted by the Planning Department (Environmental Section). The biotic assessment did not identify any listed plants, but did identify four potential special status animal species: California red-legged frog (*Rana aurora draytonii*), Coho salmon (*Oncorhynchus kisutch*), Steelhead (*Oncorhynchus mykiss*) and Western pond turtle (*Clemmys marmorata*). In addition to the species listed above, nesting migratory birds or raptors may be impacted as a result of project operations. In order to reduce potential impacts to the protected species to less than significant, the following mitigations shall be implemented:

- A qualified biologist shall meet with the construction crew prior to beginning construction to conduct a worker training session on the biotic resources and protected species in the San Lorenzo River system.
- A qualified biologist shall survey the project site for nesting birds, prior to site work if construction is planned before August 1. If active nests are found within the vicinity of the project work site, the biologist shall apply the appropriate buffer, depend upon the species, and no work shall take place within that buffer until such time as the birds have fledged.
- A qualified biologist shall survey the project site for California red-legged frogs and western pond turtles within 72 hours prior to initiation of site work. If any California red-legged frogs are observed during pre-construction surveys, U.S. Fish & Wildlife Service (USFWS) staff will be contacted and formally consulted before any ground disturbance is authorized.
- A qualified biologist shall be on site during the initial site excavation efforts, as well as installation and removal of silt and debris fencing.
- Due to the proximity to known California red-legged frog observations, daily monitoring during construction shall be conducted by the biological monitor to document that construction activities are not causing habitat degradation and/or excessive adverse water quality conditions.

	Potentially Significant Impact	Less than Significant with Mitigation Incorporated	Less than Significant Impact	No Impact
2. Have a substantial adverse effect on any riparian habitat or sensitive natural community identified in local or regional plans, policies, regulations (e.g., wetland, native grassland, special forests, intertidal zone, etc.) or by the California Department of Fish and Game or U.S. Fish and Wildlife Service?	<input type="checkbox"/>	<input type="checkbox"/>	<input checked="" type="checkbox"/>	<input type="checkbox"/>

Discussion: The project area is located within a riparian corridor and is also considered a sensitive habitat by definition within the Santa Cruz County Code (Sections 16.30 and 16.32 respectively). There will be temporary disturbance within the riparian corridor during construction activities. The slope within the project area is near vertical and will continue to add additional sediment to Bean Creek if not stabilized. The proposed project would have an overall net benefit to the riparian area and identified listed species upon completion by eliminating a source of accelerated soil erosion.

3. Interfere substantially with the movement of any native resident or migratory fish or wildlife species, or with established native resident or migratory wildlife corridors, or impede the use of native or migratory wildlife nursery sites?	<input type="checkbox"/>	<input type="checkbox"/>	<input checked="" type="checkbox"/>	<input type="checkbox"/>
--	--------------------------	--------------------------	-------------------------------------	--------------------------

Discussion: The proposed project does not involve any activities that would interfere with the movements or migrations of fish or wildlife, or impede use of a known wildlife nursery site. There will be no need to divert flow of water within the channel.

4. Produce nighttime lighting that would substantially illuminate wildlife habitats?	<input type="checkbox"/>	<input type="checkbox"/>	<input type="checkbox"/>	<input checked="" type="checkbox"/>
--	--------------------------	--------------------------	--------------------------	-------------------------------------

Discussion: Construction activities are limited to daytime hours only so nighttime lighting will not be required.

5. Have a substantial adverse effect on federally protected wetlands as defined by Section 404 of the Clean Water Act (including, but not limited to marsh, vernal pool, coastal, etc.) through direct removal, filling,	<input type="checkbox"/>	<input type="checkbox"/>	<input type="checkbox"/>	<input checked="" type="checkbox"/>
--	--------------------------	--------------------------	--------------------------	-------------------------------------

	Potentially Significant Impact	Less than Significant with Mitigation Incorporated	Less than Significant Impact	No Impact
--	--------------------------------------	--	------------------------------------	-----------

hydrological interruption, or other means?

Discussion: Wetland habitat is not present in the project area.

- | | | | | | |
|----|---|--------------------------|--------------------------|-------------------------------------|--------------------------|
| 6. | Conflict with any local policies or ordinances protecting biological resources (such as the Sensitive Habitat Ordinance, Riparian and Wetland Protection Ordinance, and the Significant Tree Protection Ordinance)? | <input type="checkbox"/> | <input type="checkbox"/> | <input checked="" type="checkbox"/> | <input type="checkbox"/> |
|----|---|--------------------------|--------------------------|-------------------------------------|--------------------------|

Discussion: The project would not conflict with any local policies or ordinances.

- | | | | | | |
|----|---|--------------------------|--------------------------|--------------------------|-------------------------------------|
| 7. | Conflict with the provisions of an adopted Habitat Conservation Plan, Natural Community Conservation Plan, or other approved local, regional, or state habitat conservation plan? | <input type="checkbox"/> | <input type="checkbox"/> | <input type="checkbox"/> | <input checked="" type="checkbox"/> |
|----|---|--------------------------|--------------------------|--------------------------|-------------------------------------|

Discussion: The proposed project would not conflict with the provisions of any adopted Habitat Conservation Plan Natural Community Conservation Plan, or other approved local, regional, or state habitat conservation plan.

D. AGRICULTURE AND FOREST RESOURCES

In determining whether impacts to agricultural resources are significant environmental effects, lead agencies may refer to the California Agricultural Land Evaluation and Site Assessment Model (1997) prepared by the California Department of Conservation as an optional model to use in assessing impacts on agriculture and farmland. In determining whether impacts to forest resources, including timberland, are significant environmental effects, lead agencies may refer to information compiled by the California Department of Forestry and Fire Protection regarding the state's inventory of forest land, including the Forest and Range Assessment Project and the Forest Legacy Assessment Project; and forest carbon measurement methodology provided in Forest Protocols adopted by the California Air Resources Board. Would the project:

- | | | | | | |
|----|---|--------------------------|--------------------------|--------------------------|-------------------------------------|
| 1. | Convert Prime Farmland, Unique Farmland, or Farmland of Statewide Importance (Farmland), as shown on the maps prepared pursuant to the Farmland Mapping and Monitoring Program of the California Resources Agency, to non-agricultural use? | <input type="checkbox"/> | <input type="checkbox"/> | <input type="checkbox"/> | <input checked="" type="checkbox"/> |
|----|---|--------------------------|--------------------------|--------------------------|-------------------------------------|

Discussion: The project site does not contain any lands designated as Prime

Potentially Significant Impact	Less than Significant with Mitigation Incorporated	Less than Significant Impact	No Impact
--------------------------------------	--	------------------------------------	-----------

Farmland, Unique Farmland, or Farmland of Statewide Importance as shown on the maps prepared pursuant to the Farmland Mapping and Monitoring Program of the California Resources Agency. In addition, the project does not contain Farmland of Local Importance. Therefore, no Prime Farmland, Unique Farmland, Farmland of Statewide or Farmland of Local Importance would be converted to a non-agricultural use. No impact would occur from project implementation.

- | | | | | | |
|----|---|--------------------------|--------------------------|--------------------------|-------------------------------------|
| 2. | Conflict with existing zoning for agricultural use, or a Williamson Act contract? | <input type="checkbox"/> | <input type="checkbox"/> | <input type="checkbox"/> | <input checked="" type="checkbox"/> |
|----|---|--------------------------|--------------------------|--------------------------|-------------------------------------|

Discussion: The project does not conflict with existing zoning for agricultural use, or a Williamson Act Contract.

- | | | | | | |
|----|---|--------------------------|--------------------------|-------------------------------------|--------------------------|
| 3. | Conflict with existing zoning for, or cause rezoning of, forest land (as defined in Public Resources Code Section 12220(g)), timberland (as defined by Public Resources Code Section 4526), or timberland zoned Timberland Production (as defined by Government Code Section 51104(g))? | <input type="checkbox"/> | <input type="checkbox"/> | <input checked="" type="checkbox"/> | <input type="checkbox"/> |
|----|---|--------------------------|--------------------------|-------------------------------------|--------------------------|

Discussion: The project is adjacent to land designated as Timber Resource but it will not affect the resource or access to harvest the resource in the future.

- | | | | | | |
|----|---|--------------------------|--------------------------|-------------------------------------|--------------------------|
| 4. | Result in the loss of forest land or conversion of forest land to non-forest use? | <input type="checkbox"/> | <input type="checkbox"/> | <input checked="" type="checkbox"/> | <input type="checkbox"/> |
|----|---|--------------------------|--------------------------|-------------------------------------|--------------------------|

Discussion: Refer to Item D3 above.

- | | | | | | |
|----|---|--------------------------|--------------------------|-------------------------------------|--------------------------|
| 5. | Involve other changes in the existing environment which, due to their location or nature, could result in conversion of Farmland, to non-agricultural use or conversion of forest land to non-forest use? | <input type="checkbox"/> | <input type="checkbox"/> | <input checked="" type="checkbox"/> | <input type="checkbox"/> |
|----|---|--------------------------|--------------------------|-------------------------------------|--------------------------|

Discussion: The project site and surrounding area within radius of 1 mile does not contain any lands designated as Prime Farmland, Unique Farmland, Farmland of Statewide Importance or Farmland of Local Importance as shown on the maps prepared pursuant to the Farmland Mapping and Monitoring Program of the California Resources Agency. Therefore, no Prime Farmland, Unique Farmland, Farmland of Statewide, or Farmland of Local Importance would be converted to a non-agricultural use. In addition, no conversion of forest land to a non-forest use will occur as a result

Potentially Significant Impact	Less than Significant with Mitigation Incorporated	Less than Significant Impact	No Impact
--------------------------------------	--	------------------------------------	-----------

of the project.

E. MINERAL RESOURCES

Would the project:

- | | | | | | |
|----|---|--------------------------|--------------------------|--------------------------|-------------------------------------|
| 1. | Result in the loss of availability of a known mineral resource that would be of value to the region and the residents of the state? | <input type="checkbox"/> | <input type="checkbox"/> | <input type="checkbox"/> | <input checked="" type="checkbox"/> |
|----|---|--------------------------|--------------------------|--------------------------|-------------------------------------|

Discussion: The site does not contain any known mineral resources that would be of value to the region and the residents of the state. Therefore, no impact is anticipated from project implementation.

- | | | | | | |
|----|--|--------------------------|--------------------------|--------------------------|-------------------------------------|
| 2. | Result in the loss of availability of a locally-important mineral resource recovery site delineated on a local general plan, specific plan or other land use plan? | <input type="checkbox"/> | <input type="checkbox"/> | <input type="checkbox"/> | <input checked="" type="checkbox"/> |
|----|--|--------------------------|--------------------------|--------------------------|-------------------------------------|

Discussion: The project site is within the county's right-of-way and does not have a specific zone district, nor does it have a Land Use Designation with a Quarry Designation Overlay (Q) (County of Santa Cruz 1994). Therefore, no potentially significant loss of availability of a known mineral resource of locally important mineral resource recovery (extraction) site delineated on a local general plan, specific plan or other land use plan would occur as a result of this project.

F. VISUAL RESOURCES AND AESTHETICS

Would the project:

- | | | | | | |
|----|---|--------------------------|--------------------------|--------------------------|-------------------------------------|
| 1. | Have an adverse effect on a scenic vista? | <input type="checkbox"/> | <input type="checkbox"/> | <input type="checkbox"/> | <input checked="" type="checkbox"/> |
|----|---|--------------------------|--------------------------|--------------------------|-------------------------------------|

Discussion: The project will not directly impact any public scenic resources, as designated in the County's General Plan (1994), or obstruct any public views of these visual resources.

- | | | | | | |
|----|--|--------------------------|--------------------------|--------------------------|-------------------------------------|
| 2. | Substantially damage scenic resources, within a designated scenic corridor or public view shed area including, but not limited to, trees, rock outcroppings, and historic buildings within a state scenic highway? | <input type="checkbox"/> | <input type="checkbox"/> | <input type="checkbox"/> | <input checked="" type="checkbox"/> |
|----|--|--------------------------|--------------------------|--------------------------|-------------------------------------|

Discussion: The project site is not located along a County designated scenic road, public viewshed area, scenic corridor, within a designated scenic resource area, or within a state scenic highway. Therefore, no impact is anticipated.

	Potentially Significant Impact	Less than Significant with Mitigation Incorporated	Less than Significant Impact	No Impact
3. Substantially degrade the existing visual character or quality of the site and its surroundings, including substantial change in topography or ground surface relief features, and/or development on a ridgeline?	<input type="checkbox"/>	<input type="checkbox"/>	<input checked="" type="checkbox"/>	<input type="checkbox"/>

Discussion: The existing visual setting consists of a two lane roadway adjacent to a well vegetated riparian corridor. The proposed project is designed and landscaped so as to fit into this setting.

4. Create a new source of substantial light or glare which would adversely affect day or nighttime views in the area?	<input type="checkbox"/>	<input type="checkbox"/>	<input type="checkbox"/>	<input checked="" type="checkbox"/>
---	--------------------------	--------------------------	--------------------------	-------------------------------------

Discussion: No new sources of light or glare are proposed as part of this road repair project.

G. CULTURAL RESOURCES

Would the project:

1. Cause a substantial adverse change in the significance of a historical resource as defined in CEQA Guidelines Section 15064.5?	<input type="checkbox"/>	<input type="checkbox"/>	<input type="checkbox"/>	<input checked="" type="checkbox"/>
---	--------------------------	--------------------------	--------------------------	-------------------------------------

Discussion: No historical resource identified.

2. Cause a substantial adverse change in the significance of an archaeological resource pursuant to CEQA Guidelines Section 15064.5?	<input type="checkbox"/>	<input type="checkbox"/>	<input checked="" type="checkbox"/>	<input type="checkbox"/>
--	--------------------------	--------------------------	-------------------------------------	--------------------------

Discussion: No archeological resources have been identified in the project area. Pursuant to County Code Section 16.40.040, if at any time in the preparation for or process of excavating or otherwise disturbing the ground, any human remains of any age, or any artifact or other evidence of a Native American cultural site which reasonably appears to exceed 100 years of age are discovered, the responsible persons shall immediately cease and desist from all further site excavation and comply with the notification procedures given in County Code Chapter 16.40.040.

3. Disturb any human remains, including those interred outside of formal cemeteries?	<input type="checkbox"/>	<input type="checkbox"/>	<input checked="" type="checkbox"/>	<input type="checkbox"/>
--	--------------------------	--------------------------	-------------------------------------	--------------------------

Discussion: Pursuant to Section 16.40.040 of the Santa Cruz County Code, if at any

Potentially Significant Impact	Less than Significant with Mitigation Incorporated	Less than Significant Impact	No Impact
--------------------------------------	--	------------------------------------	-----------

time during site preparation, excavation, or other ground disturbance associated with this project, human remains are discovered, the responsible persons shall immediately cease and desist from all further site excavation and notify the sheriff-coroner and the Planning Director. If the coroner determines that the remains are not of recent origin, a full archeological report shall be prepared and representatives of the local Native California Indian group shall be contacted. Disturbance shall not resume until the significance of the archeological resource is determined and appropriate mitigations to preserve the resource on the site are established.

- | | | | | |
|---|--------------------------|--------------------------|--------------------------|-------------------------------------|
| 4. Directly or indirectly destroy a unique paleontological resource or site or unique geologic feature? | <input type="checkbox"/> | <input type="checkbox"/> | <input type="checkbox"/> | <input checked="" type="checkbox"/> |
|---|--------------------------|--------------------------|--------------------------|-------------------------------------|

Discussion: No unique paleontological resources, sites, or geological features have been identified within the proposed disturbance area.

H. HAZARDS AND HAZARDOUS MATERIALS

Would the project:

- | | | | | |
|---|--------------------------|--------------------------|-------------------------------------|--------------------------|
| 1. Create a significant hazard to the public or the environment as a result of the routine transport, use or disposal of hazardous materials? | <input type="checkbox"/> | <input type="checkbox"/> | <input checked="" type="checkbox"/> | <input type="checkbox"/> |
|---|--------------------------|--------------------------|-------------------------------------|--------------------------|

Discussion: The construction equipment would be maintained in proper operating condition to prevent leaks of oil and/or grease.

- | | | | | |
|---|--------------------------|--------------------------|-------------------------------------|--------------------------|
| 2. Create a significant hazard to the public or the environment through reasonably foreseeable upset and accident conditions involving the release of hazardous materials into the environment? | <input type="checkbox"/> | <input type="checkbox"/> | <input checked="" type="checkbox"/> | <input type="checkbox"/> |
|---|--------------------------|--------------------------|-------------------------------------|--------------------------|

Discussion: Refer to H.1. above.

- | | | | | |
|---|--------------------------|--------------------------|--------------------------|-------------------------------------|
| 3. Emit hazardous emissions or handle hazardous or acutely hazardous materials, substances, or waste within one-quarter mile of an existing or proposed school? | <input type="checkbox"/> | <input type="checkbox"/> | <input type="checkbox"/> | <input checked="" type="checkbox"/> |
|---|--------------------------|--------------------------|--------------------------|-------------------------------------|

Discussion: No hazardous emissions, materials, substances, or waste are associated with the proposed project.

- | | Potentially
Significant
Impact | Less than
Significant
with
Mitigation
Incorporated | Less than
Significant
Impact | No Impact |
|--|--------------------------------------|--|------------------------------------|-------------------------------------|
| 4. Be located on a site which is included on a list of hazardous materials sites compiled pursuant to Government Code Section 65962.5 and, as a result, would it create a significant hazard to the public or the environment? | <input type="checkbox"/> | <input type="checkbox"/> | <input type="checkbox"/> | <input checked="" type="checkbox"/> |

Discussion: The project site is not included on the September 3, 2010 list of hazardous sites in Santa Cruz County compiled pursuant to the specified code.

- | | | | | |
|--|--------------------------|--------------------------|--------------------------|-------------------------------------|
| 5. For a project located within an airport land use plan or, where such a plan has not been adopted, within two miles of a public airport or public use airport, would the project result in a safety hazard for people residing or working in the project area? | <input type="checkbox"/> | <input type="checkbox"/> | <input type="checkbox"/> | <input checked="" type="checkbox"/> |
|--|--------------------------|--------------------------|--------------------------|-------------------------------------|

Discussion: No airport located within two miles of the project area.

- | | | | | |
|---|--------------------------|--------------------------|--------------------------|-------------------------------------|
| 6. For a project within the vicinity of a private airstrip, would the project result in a safety hazard for people residing or working in the project area? | <input type="checkbox"/> | <input type="checkbox"/> | <input type="checkbox"/> | <input checked="" type="checkbox"/> |
|---|--------------------------|--------------------------|--------------------------|-------------------------------------|

Discussion: No private airstrip within the vicinity of the project area.

- | | | | | |
|---|--------------------------|--------------------------|-------------------------------------|--------------------------|
| 7. Impair implementation of or physically interfere with an adopted emergency response plan or emergency evacuation plan? | <input type="checkbox"/> | <input type="checkbox"/> | <input checked="" type="checkbox"/> | <input type="checkbox"/> |
|---|--------------------------|--------------------------|-------------------------------------|--------------------------|

Discussion: The proposed project does not conflict with the County's adopted Emergency Management Plan (April 2002).

- | | | | | |
|--|--------------------------|--------------------------|--------------------------|-------------------------------------|
| 8. Expose people to electro-magnetic fields associated with electrical transmission lines? | <input type="checkbox"/> | <input type="checkbox"/> | <input type="checkbox"/> | <input checked="" type="checkbox"/> |
|--|--------------------------|--------------------------|--------------------------|-------------------------------------|

Discussion: No transmission lines near the project area.

	Potentially Significant Impact	Less than Significant with Mitigation Incorporated	Less than Significant Impact	No Impact
9. Expose people or structures to a significant risk of loss, injury or death involving wildland fires, including where wildlands are adjacent to urbanized areas or where residences are intermixed with wildlands?	<input type="checkbox"/>	<input type="checkbox"/>	<input type="checkbox"/>	<input checked="" type="checkbox"/>

Discussion: The project is to repair a minor roadway slipout along a county maintained roadway.

I. TRANSPORTATION/TRAFFIC

Would the project:

1. Conflict with an applicable plan, ordinance or policy establishing measures of effectiveness for the performance of the circulation system, taking into account all modes of transportation including mass transit and non-motorized travel and relevant components of the circulation system, including but not limited to intersections, streets, highways and freeways, pedestrian and bicycle paths, and mass transit?	<input type="checkbox"/>	<input type="checkbox"/>	<input type="checkbox"/>	<input checked="" type="checkbox"/>
---	--------------------------	--------------------------	--------------------------	-------------------------------------

Discussion: There will be no impact because no additional traffic will be generated.

2. Result in a change in air traffic patterns, including either an increase in traffic levels or a change in location that results in substantial safety risks?	<input type="checkbox"/>	<input type="checkbox"/>	<input type="checkbox"/>	<input checked="" type="checkbox"/>
---	--------------------------	--------------------------	--------------------------	-------------------------------------

Discussion: The proposed project does not impact air traffic patterns, therefore there is no impact.

3. Substantially increase hazards due to a design feature (e.g., sharp curves or dangerous intersections) or incompatible uses (e.g., farm equipment)?	<input type="checkbox"/>	<input type="checkbox"/>	<input type="checkbox"/>	<input checked="" type="checkbox"/>
--	--------------------------	--------------------------	--------------------------	-------------------------------------

Discussion: The proposed roadside repair does not change the original road alignment or use.

	Potentially Significant Impact	Less than Significant with Mitigation Incorporated	Less than Significant Impact	No Impact
4. Result in inadequate emergency access?	<input type="checkbox"/>	<input type="checkbox"/>	<input checked="" type="checkbox"/>	<input type="checkbox"/>

Discussion: One lane will remain open at all times. Fire trucks, ambulances and other emergency vehicles will not be blocked from using the road at any time.

5. Cause an increase in parking demand which cannot be accommodated by existing parking facilities?	<input type="checkbox"/>	<input type="checkbox"/>	<input type="checkbox"/>	<input checked="" type="checkbox"/>
---	--------------------------	--------------------------	--------------------------	-------------------------------------

Discussion: The proposed project does not include parking features.

6. Conflict with adopted policies, plans, or programs regarding public transit, bicycle, or pedestrian facilities, or otherwise decrease the performance or safety of such facilities?	<input type="checkbox"/>	<input type="checkbox"/>	<input checked="" type="checkbox"/>	<input type="checkbox"/>
--	--------------------------	--------------------------	-------------------------------------	--------------------------

Discussion: The proposed project would comply with current road requirements to prevent potential hazards to motorists, bicyclists, and/or pedestrians.

7. Exceed, either individually (the project alone) or cumulatively (the project combined with other development), a level of service standard established by the County General Plan for designated intersections, roads or highways?	<input type="checkbox"/>	<input type="checkbox"/>	<input type="checkbox"/>	<input checked="" type="checkbox"/>
---	--------------------------	--------------------------	--------------------------	-------------------------------------

Discussion: See response I-1 above.

J. NOISE

Would the project result in:

1. A substantial permanent increase in ambient noise levels in the project vicinity above levels existing without the project?	<input type="checkbox"/>	<input type="checkbox"/>	<input type="checkbox"/>	<input checked="" type="checkbox"/>
--	--------------------------	--------------------------	--------------------------	-------------------------------------

Discussion: No substantial permanent increase in ambient noise levels would be generated as part of the proposed project.

2. Exposure of persons to or generation of excessive groundborne vibration or groundborne noise levels?	<input type="checkbox"/>	<input type="checkbox"/>	<input checked="" type="checkbox"/>	<input type="checkbox"/>
---	--------------------------	--------------------------	-------------------------------------	--------------------------

Discussion: Groundborne vibration or groundbourne noise levels may occur during construction activities, but would be temporary in nature.

- | | Potentially
Significant
Impact | Less than
Significant
with
Mitigation
Incorporated | Less than
Significant
Impact | No Impact |
|---|--------------------------------------|--|-------------------------------------|--------------------------|
| 3. Exposure of persons to or generation of noise levels in excess of standards established in the General Plan or noise ordinance, or applicable standards of other agencies? | <input type="checkbox"/> | <input type="checkbox"/> | <input checked="" type="checkbox"/> | <input type="checkbox"/> |

Discussion: Per County policy, average hourly noise levels shall not exceed the General Plan threshold of 50 Leq during the day and 45 Leq during the nighttime. Impulsive noise levels shall not exceed 65 db during the day or 60 db at night. Due to the remote setting, it is not anticipated that sound levels beyond the general work site location will exceed standards

- | | | | | |
|--|--------------------------|--------------------------|-------------------------------------|--------------------------|
| 4. A substantial temporary or periodic increase in ambient noise levels in the project vicinity above levels existing without the project? | <input type="checkbox"/> | <input type="checkbox"/> | <input checked="" type="checkbox"/> | <input type="checkbox"/> |
|--|--------------------------|--------------------------|-------------------------------------|--------------------------|

Discussion: Noise generated during construction will increase the ambient noise levels for adjoining areas. Construction will be temporary, however, and given the limited duration of this impact it is considered to be less than significant.

- | | | | | |
|---|--------------------------|--------------------------|--------------------------|-------------------------------------|
| 5. For a project located within an airport land use plan or, where such a plan has not been adopted, within two miles of a public airport or public use airport, would the project expose people residing or working in the project area to excessive noise levels? | <input type="checkbox"/> | <input type="checkbox"/> | <input type="checkbox"/> | <input checked="" type="checkbox"/> |
|---|--------------------------|--------------------------|--------------------------|-------------------------------------|

Discussion: The project site is not located within an airport land use plan or within two miles of a public airport and therefore, there is no impact.

- | | | | | |
|--|--------------------------|--------------------------|--------------------------|-------------------------------------|
| 6. For a project within the vicinity of a private airstrip, would the project expose people residing or working in the project area to excessive noise levels? | <input type="checkbox"/> | <input type="checkbox"/> | <input type="checkbox"/> | <input checked="" type="checkbox"/> |
|--|--------------------------|--------------------------|--------------------------|-------------------------------------|

Discussion: The project site is not located within the vicinity of a private airstrip, therefore, there is no impact.

Potentially Significant Impact	Less than Significant with Mitigation Incorporated	Less than Significant Impact	No Impact
--------------------------------------	--	------------------------------------	-----------

K. AIR QUALITY

Where available, the significance criteria established by the Monterey Bay Unified Air Pollution Control District (MBUAPCD) may be relied upon to make the following determinations. Would the project:

- | | | | | |
|--|--------------------------|--------------------------|-------------------------------------|--------------------------|
| 1. Violate any air quality standard or contribute substantially to an existing or projected air quality violation? | <input type="checkbox"/> | <input type="checkbox"/> | <input checked="" type="checkbox"/> | <input type="checkbox"/> |
|--|--------------------------|--------------------------|-------------------------------------|--------------------------|

Discussion: The North Central Coast Air Basin does not meet state standards for ozone and particulate matter (PM₁₀). Therefore, the regional pollutants of concern that would be emitted by the project are ozone precursors (Volatile Organic Compounds [VOCs] and nitrogen oxides [NO_x]), and dust.

Given the modest amount of new traffic that will be generated by the project there is no indication that new emissions of VOCs or NO_x will exceed MBUAPCD thresholds for these pollutants and therefore there will not be a significant contribution to an existing air quality violation.

Project construction may result in a short-term, localized decrease in air quality due to generation of dust. However, standard dust control best management practices, such as periodic watering, will be implemented during construction to reduce impacts to a less than significant level.

- | | | | | |
|---|--------------------------|--------------------------|-------------------------------------|--------------------------|
| 2. Conflict with or obstruct implementation of the applicable air quality plan? | <input type="checkbox"/> | <input type="checkbox"/> | <input checked="" type="checkbox"/> | <input type="checkbox"/> |
|---|--------------------------|--------------------------|-------------------------------------|--------------------------|

Discussion: The project will not conflict with or obstruct implementation of the regional air quality plan. See K-1 above.

- | | | | | |
|---|--------------------------|--------------------------|-------------------------------------|--------------------------|
| 3. Result in a cumulatively considerable net increase of any criteria pollutant for which the project region is non-attainment under an applicable federal or state ambient air quality standard (including releasing emissions which exceed quantitative thresholds for ozone precursors)? | <input type="checkbox"/> | <input type="checkbox"/> | <input checked="" type="checkbox"/> | <input type="checkbox"/> |
|---|--------------------------|--------------------------|-------------------------------------|--------------------------|

Discussion: See K-1 above.

- | | | | | |
|--|--------------------------|--------------------------|-------------------------------------|--------------------------|
| 4. Expose sensitive receptors to substantial pollutant concentrations? | <input type="checkbox"/> | <input type="checkbox"/> | <input checked="" type="checkbox"/> | <input type="checkbox"/> |
|--|--------------------------|--------------------------|-------------------------------------|--------------------------|

Discussion: Construction activities may result in a short term localized decrease in air quality due to generation of dust. Standard dust control BMPs are included in the

Potentially Significant Impact	Less than Significant with Mitigation Incorporated	Less than Significant Impact	No Impact
--------------------------------------	--	------------------------------------	-----------

project specifications and shall be implemented, if necessary, so air quality impacts associated with construction shall be at a less than significant level.

5. Create objectionable odors affecting a substantial number of people? ☐ ☐ ☒ ☐

Discussion: The project does not include any process or material expected to create objectionable odors.

L. GREENHOUSE GAS EMISSIONS

Would the project:

1. Generate greenhouse gas emissions, either directly or indirectly, that may have a significant impact on the environment? ☐ ☐ ☒ ☐

Discussion: The proposed project, like all development, would be responsible for an incremental increase in green house gas emissions by usage of fossil fuels during the site grading and construction. At this time, Santa Cruz County is in the process of developing a Climate Action Plan (CAP) intended to establish specific emission reduction goals and necessary actions to reduce greenhouse gas levels to pre-1990 levels as required under AB 32 legislation. Until the CAP is completed, there are no specific standards or criteria to apply to this project. All project construction equipment would be required to comply with the Regional Air Quality Control Board emissions requirements for construction equipment. As a result, impacts associated with the temporary increase in green house gas emissions are expected to be less than significant.

2. Conflict with an applicable plan, policy or regulation adopted for the purpose of reducing the emissions of greenhouse gases? ☐ ☐ ☒ ☐

Discussion: See the discussion under L-1 above. No significant impacts are anticipated.

M. PUBLIC SERVICES

Would the project:

1. Result in substantial adverse physical impacts associated with the provision of new or physically altered governmental facilities, need for new or physically altered governmental facilities, the construction of which could cause significant environmental

Potentially Significant Impact	Less than Significant with Mitigation Incorporated	Less than Significant Impact	No Impact
--------------------------------------	--	------------------------------------	-----------

impacts, in order to maintain acceptable service ratios, response times, or other performance objectives for any of the public services:

- | | | | | |
|---------------------|--------------------------|--------------------------|-------------------------------------|--------------------------|
| a. Fire protection? | <input type="checkbox"/> | <input type="checkbox"/> | <input checked="" type="checkbox"/> | <input type="checkbox"/> |
|---------------------|--------------------------|--------------------------|-------------------------------------|--------------------------|

No additional housing is proposed; the project will not create a significant demand for new services, nor will it require additional personnel.

- | | | | | |
|-----------------------|--------------------------|--------------------------|-------------------------------------|--------------------------|
| b. Police protection? | <input type="checkbox"/> | <input type="checkbox"/> | <input checked="" type="checkbox"/> | <input type="checkbox"/> |
|-----------------------|--------------------------|--------------------------|-------------------------------------|--------------------------|

Refer to K.1a above.

- | | | | | |
|-------------|--------------------------|--------------------------|-------------------------------------|--------------------------|
| c. Schools? | <input type="checkbox"/> | <input type="checkbox"/> | <input checked="" type="checkbox"/> | <input type="checkbox"/> |
|-------------|--------------------------|--------------------------|-------------------------------------|--------------------------|

This project is not creating new housing so an incremental contribution for new school services does not exist.

- | | | | | |
|--|--------------------------|--------------------------|-------------------------------------|--------------------------|
| d. Parks or other recreational activities? | <input type="checkbox"/> | <input type="checkbox"/> | <input checked="" type="checkbox"/> | <input type="checkbox"/> |
|--|--------------------------|--------------------------|-------------------------------------|--------------------------|

The project will not create a significant demand for new services.

- | | | | | |
|---|--------------------------|--------------------------|-------------------------------------|--------------------------|
| e. Other public facilities; including the maintenance of roads? | <input type="checkbox"/> | <input type="checkbox"/> | <input checked="" type="checkbox"/> | <input type="checkbox"/> |
|---|--------------------------|--------------------------|-------------------------------------|--------------------------|

Discussion (a through e): The project proposed is to re-construct the existing roadway back to pre-storm damage condition.

N. RECREATION

Would the project:

- | | | | | |
|--|--------------------------|--------------------------|--------------------------|-------------------------------------|
| 1. Would the project increase the use of existing neighborhood and regional parks or other recreational facilities such that substantial physical deterioration of the facility would occur or be accelerated? | <input type="checkbox"/> | <input type="checkbox"/> | <input type="checkbox"/> | <input checked="" type="checkbox"/> |
|--|--------------------------|--------------------------|--------------------------|-------------------------------------|

Discussion: The project involves repair of a county maintained roadway and will not impact existing neighborhood and regional parks or other recreational facilities.

- | | | | | |
|---|--------------------------|--------------------------|--------------------------|-------------------------------------|
| 2. Does the project include recreational facilities or require the construction or expansion of recreational facilities which might have an adverse physical effect on the environment? | <input type="checkbox"/> | <input type="checkbox"/> | <input type="checkbox"/> | <input checked="" type="checkbox"/> |
|---|--------------------------|--------------------------|--------------------------|-------------------------------------|

Discussion: Refer to N.1. above.

Potentially Significant Impact	Less than Significant with Mitigation Incorporated	Less than Significant Impact	No Impact
--------------------------------------	--	------------------------------------	-----------

O. UTILITIES AND SERVICE SYSTEMS

Would the project:

- | | | | | |
|---|--------------------------|--------------------------|--------------------------|-------------------------------------|
| 1. Require or result in the construction of new storm water drainage facilities or expansion of existing facilities, the construction of which could cause significant environmental effects? | <input type="checkbox"/> | <input type="checkbox"/> | <input type="checkbox"/> | <input checked="" type="checkbox"/> |
|---|--------------------------|--------------------------|--------------------------|-------------------------------------|

Discussion: No new storm water drainage facilities or expansion of existing facilities are proposed as part of this project.

- | | | | | |
|--|--------------------------|--------------------------|--------------------------|-------------------------------------|
| 2. Require or result in the construction of new water or wastewater treatment facilities or expansion of existing facilities, the construction of which could cause significant environmental effects? | <input type="checkbox"/> | <input type="checkbox"/> | <input type="checkbox"/> | <input checked="" type="checkbox"/> |
|--|--------------------------|--------------------------|--------------------------|-------------------------------------|

Discussion: No new water or wastewater treatment facilities or expansion of existing facilities are proposed as part of this project.

- | | | | | |
|---|--------------------------|--------------------------|--------------------------|-------------------------------------|
| 3. Exceed wastewater treatment requirements of the applicable Regional Water Quality Control Board? | <input type="checkbox"/> | <input type="checkbox"/> | <input type="checkbox"/> | <input checked="" type="checkbox"/> |
|---|--------------------------|--------------------------|--------------------------|-------------------------------------|

Discussion: Refer to O.2. above.

- | | | | | |
|--|--------------------------|--------------------------|--------------------------|-------------------------------------|
| 4. Have sufficient water supplies available to serve the project from existing entitlements and resources, or are new or expanded entitlements needed? | <input type="checkbox"/> | <input type="checkbox"/> | <input type="checkbox"/> | <input checked="" type="checkbox"/> |
|--|--------------------------|--------------------------|--------------------------|-------------------------------------|

Discussion: No existing or new entitlements are involved in the proposed project.

- | | | | | |
|---|--------------------------|--------------------------|--------------------------|-------------------------------------|
| 5. Result in determination by the wastewater treatment provider which serves or may serve the project that it has adequate capacity to serve the project's projected demand in addition to the provider's existing commitments? | <input type="checkbox"/> | <input type="checkbox"/> | <input type="checkbox"/> | <input checked="" type="checkbox"/> |
|---|--------------------------|--------------------------|--------------------------|-------------------------------------|

Discussion: Refer to O.2. above.

- | | Potentially
Significant
Impact | Less than
Significant
with
Mitigation
Incorporated | Less than
Significant
Impact | No Impact |
|--|--------------------------------------|--|-------------------------------------|--------------------------|
| 6. Be served by a landfill with sufficient permitted capacity to accommodate the project's solid waste disposal needs? | <input type="checkbox"/> | <input type="checkbox"/> | <input checked="" type="checkbox"/> | <input type="checkbox"/> |

Discussion: The project is expected to generate minimal waste and the nearby landfill has sufficient capacity to accommodate expected solid waste disposal.

- | | | | | |
|---|--------------------------|--------------------------|-------------------------------------|--------------------------|
| 7. Comply with federal, state, and local statutes and regulations related to solid waste? | <input type="checkbox"/> | <input type="checkbox"/> | <input checked="" type="checkbox"/> | <input type="checkbox"/> |
|---|--------------------------|--------------------------|-------------------------------------|--------------------------|

Discussion: Yes

P. LAND USE AND PLANNING

Would the project:

- | | | | | |
|---|--------------------------|--------------------------|-------------------------------------|--------------------------|
| 1. Conflict with any applicable land use plan, policy, or regulation of an agency with jurisdiction over the project (including, but not limited to the general plan, specific plan, local coastal program, or zoning ordinance) adopted for the purpose of avoiding or mitigating an environmental effect? | <input type="checkbox"/> | <input type="checkbox"/> | <input checked="" type="checkbox"/> | <input type="checkbox"/> |
|---|--------------------------|--------------------------|-------------------------------------|--------------------------|

Discussion: General Plan policy 5.2.3 (Activities Within Riparian Corridors & Wetlands) states: "Development activities, land alteration and vegetation disturbance within riparian corridors and wetlands and required buffers shall be prohibited unless an exception is granted per the Riparian Corridor and Wetlands Protection ordinance". The five "Findings" required (County Code Section: 16.30.060) to be made in order to grant the exception can be made for the proposed project.

- | | | | | |
|---|--------------------------|--------------------------|--------------------------|-------------------------------------|
| 2. Conflict with any applicable habitat conservation plan or natural community conservation plan? | <input type="checkbox"/> | <input type="checkbox"/> | <input type="checkbox"/> | <input checked="" type="checkbox"/> |
|---|--------------------------|--------------------------|--------------------------|-------------------------------------|

Discussion: None present in the project vicinity.

- | | | | | |
|--|--------------------------|--------------------------|--------------------------|-------------------------------------|
| 3. Physically divide an established community? | <input type="checkbox"/> | <input type="checkbox"/> | <input type="checkbox"/> | <input checked="" type="checkbox"/> |
|--|--------------------------|--------------------------|--------------------------|-------------------------------------|

Discussion: The project proposed is to re-construct the existing roadway back to pre-storm damage condition and will not divide an established community.

Potentially Significant Impact	Less than Significant with Mitigation Incorporated	Less than Significant Impact	No Impact
--------------------------------------	--	------------------------------------	-----------

Q. POPULATION AND HOUSING

Would the project:

- | | | | | |
|---|--------------------------|--------------------------|-------------------------------------|--------------------------|
| 1. Induce substantial population growth in an area, either directly (for example, by proposing new homes and businesses) or indirectly (for example, through extension of roads or other infrastructure)? | <input type="checkbox"/> | <input type="checkbox"/> | <input checked="" type="checkbox"/> | <input type="checkbox"/> |
|---|--------------------------|--------------------------|-------------------------------------|--------------------------|

Discussion: The proposed project would not induce substantial population growth in an area because the project does not propose any physical or regulatory change that would remove a restriction to or encourage population growth in an area. The project does not involve extensions of utilities (e.g., water, sewer, or new road systems) into areas previously not served. Consequently, it is not expected to have a significant growth-inducing effect.

- | | | | | |
|---|--------------------------|--------------------------|--------------------------|-------------------------------------|
| 2. Displace substantial numbers of existing housing, necessitating the construction of replacement housing elsewhere? | <input type="checkbox"/> | <input type="checkbox"/> | <input type="checkbox"/> | <input checked="" type="checkbox"/> |
|---|--------------------------|--------------------------|--------------------------|-------------------------------------|

Discussion: The proposed project would not displace any existing housing.

- | | | | | |
|---|--------------------------|--------------------------|--------------------------|-------------------------------------|
| 3. Displace substantial numbers of people, necessitating the construction of replacement housing elsewhere? | <input type="checkbox"/> | <input type="checkbox"/> | <input type="checkbox"/> | <input checked="" type="checkbox"/> |
|---|--------------------------|--------------------------|--------------------------|-------------------------------------|

Discussion: The proposed project will not entail a gain of or demolition of housing units.

R. MANDATORY FINDINGS OF SIGNIFICANCE

- | | Potentially
Significant
Impact | Less than
Significant
with
Mitigation | Less than
Significant
Impact | No
Impact |
|---|--------------------------------------|--|-------------------------------------|--------------------------|
| 1. Does the project have the potential to degrade the quality of the environment, substantially reduce the habitat of a fish or wildlife species, cause a fish or wildlife population to drop below self-sustaining levels, threaten to eliminate a plant or animal community, reduce the number or restrict the range of a rare or endangered plant or animal community, reduce the number or restrict the range of a rare or endangered plant or animal or eliminate important examples of the major periods of California history or prehistory? | <input type="checkbox"/> | <input type="checkbox"/> | <input checked="" type="checkbox"/> | <input type="checkbox"/> |

Discussion: The potential to degrade the quality of the environment, substantially reduce the habitat of a fish or wildlife species, cause a fish or wildlife population to drop below self-sustaining levels, threaten to eliminate a plant or animal community, reduce the number or restrict the range of a rare or endangered plant or animal or eliminate important examples of the major periods of California history or prehistory were considered in the response to each question in Section III of this Initial Study. This project has been determined not to meet this Mandatory Finding of Significance.

- | | Potentially
Significant
Impact | Less than
Significant
with
Mitigation | Less than
Significant
Impact | No
Impact |
|--|--------------------------------------|--|-------------------------------------|--------------------------|
| 2. Does the project have impacts that are individually limited, but cumulatively considerable? ("cumulatively considerable" means that the incremental effects of a project are considerable when viewed in connection with the effects of past projects, the effects of other current projects, and the effects of probable future projects)? | <input type="checkbox"/> | <input type="checkbox"/> | <input checked="" type="checkbox"/> | <input type="checkbox"/> |

Discussion: As a result of this evaluation, there is no substantial evidence that there are cumulative effects associated with this project. Therefore, this project has been determined not to meet this Mandatory Finding of Significance.

- | | Potentially
Significant
Impact | Less than
Significant
with
Mitigation | Less than
Significant
Impact | No
Impact |
|---|--------------------------------------|--|-------------------------------------|--------------------------|
| 3. Does the project have environmental effects which will cause substantial adverse effects on human beings, either directly or indirectly? | <input type="checkbox"/> | <input type="checkbox"/> | <input checked="" type="checkbox"/> | <input type="checkbox"/> |

Discussion: As a result of this evaluation, there is no substantial evidence that there are adverse effects to human beings associated with this project. Therefore, this project has been determined not to meet this Mandatory Finding of Significance.

IV. TECHNICAL REVIEW CHECKLIST

	<u>REQUIRED</u>	<u>DATE COMPLETED</u>
Agricultural Policy Advisory Commission (APAC) Review	Yes <input type="checkbox"/> No <input checked="" type="checkbox"/>	_____
Archaeological Review	Yes <input type="checkbox"/> No <input checked="" type="checkbox"/>	_____
Biotic Report/Assessment	Yes <input checked="" type="checkbox"/> No <input type="checkbox"/>	<u>March 31, 2008</u>
Geologic Hazards Assessment (GHA)	Yes <input type="checkbox"/> No <input checked="" type="checkbox"/>	_____
Geologic Report	Yes <input type="checkbox"/> No <input checked="" type="checkbox"/>	_____
Geotechnical (Soils) Report	Yes <input type="checkbox"/> No <input checked="" type="checkbox"/>	_____
Riparian Pre-Site	Yes <input type="checkbox"/> No <input checked="" type="checkbox"/>	_____
Septic Lot Check	Yes <input type="checkbox"/> No <input checked="" type="checkbox"/>	_____
Other:	Yes <input type="checkbox"/> No <input checked="" type="checkbox"/>	_____

V. REFERENCES USED IN THE COMPLETION OF THIS ENVIRONMENTAL REVIEW INITIAL STUDY

County of Santa Cruz *1994 General Plan and Local Coastal Program*. Adopted by the Board of Supervisors on May 24, 1994, and certified by the California Coastal Commission on December 15, 1994.

VI. ATTACHMENTS

1. *Location Map.*
2. *Project Plans (Sheet 1)*
3. *Biotic Assessment*, prepared by Kittleson Environmental Consulting, dated March 31, 2008.

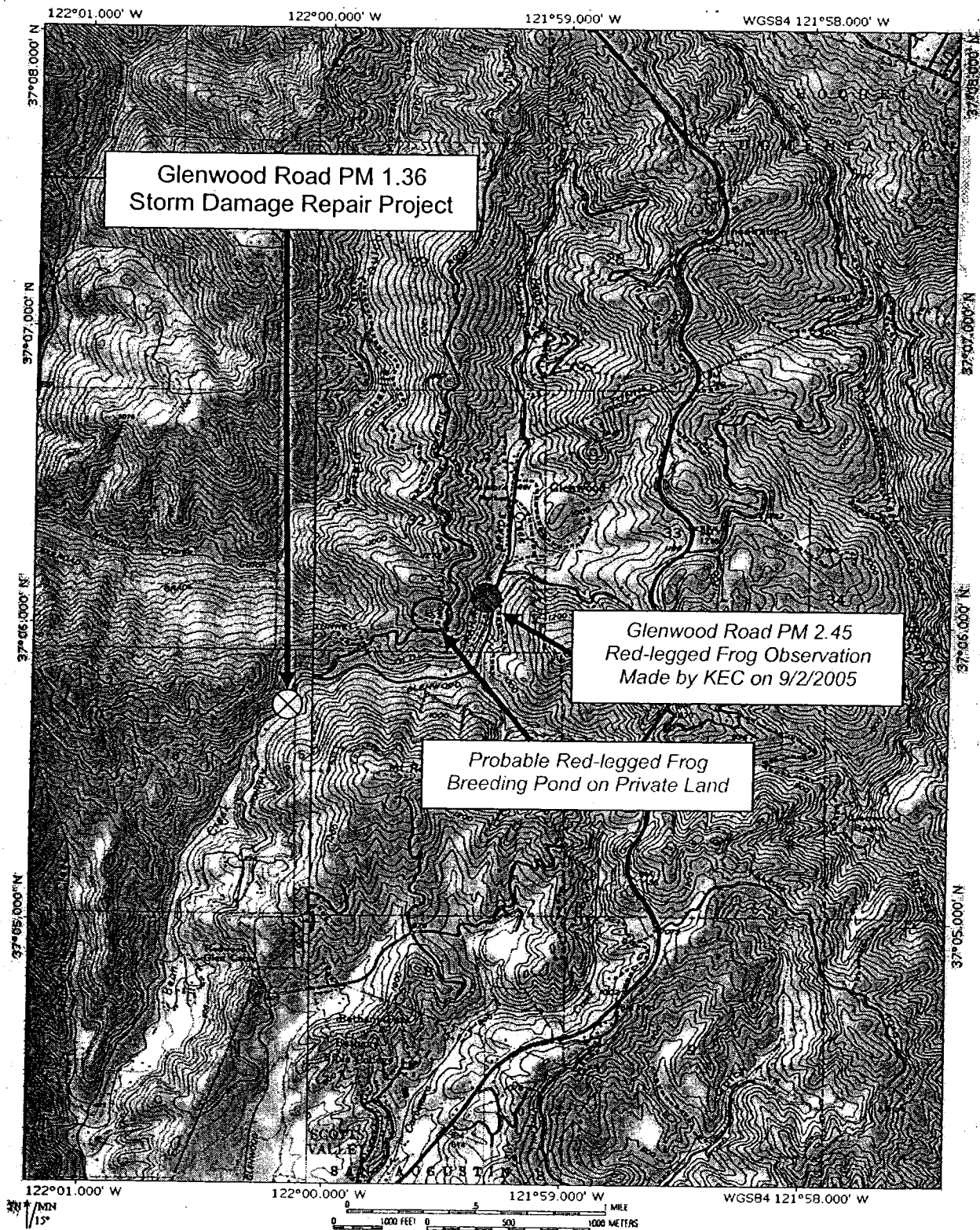

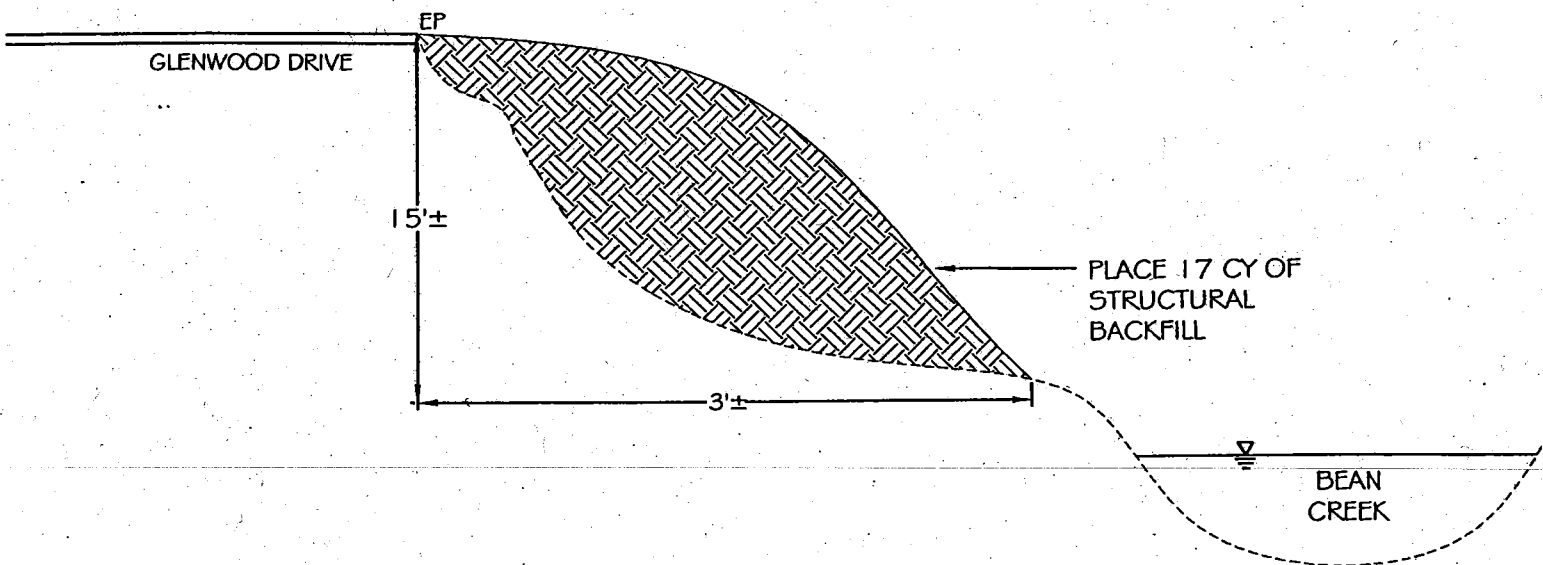
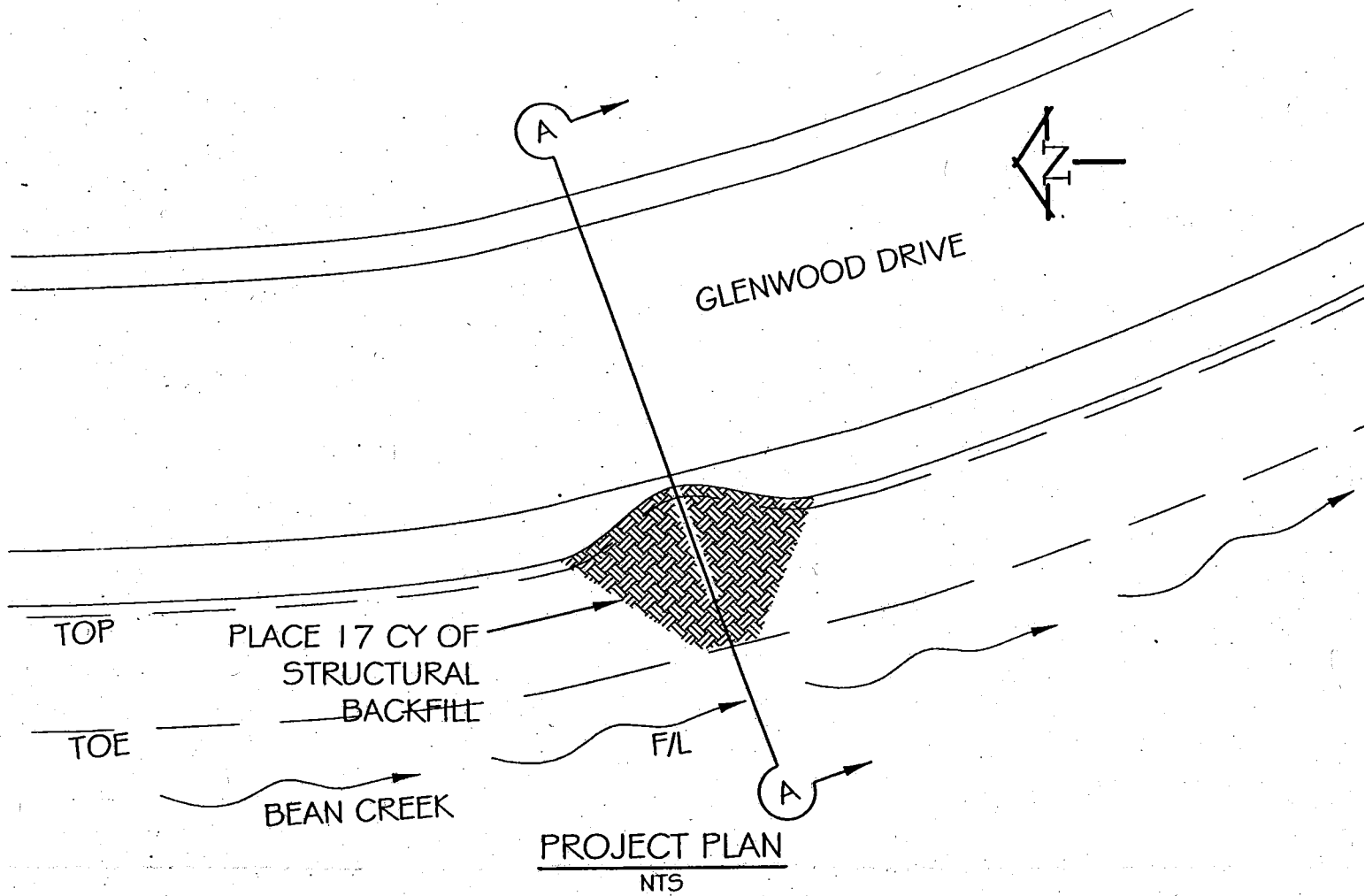

SECTION A - A
N.T.S.

**Biotic Assessment and Suggested Mitigation Measures
Glenwood Road PM 1.36 Storm Damage Repair**

March 31, 2008

Project Description

The County of Santa Cruz proposes to repair a failing road embankment on Glenwood Road at PM 1.36 in the Bean Creek subwatershed watershed with the San Lorenzo River watershed in Santa Cruz County. The area of concern is small pavement failure and road embankment above Bean Creek. As proposed, the emergency repair will fill the eroded area with 16.9 cubic yards of compacted fill and provide erosion control the roadway shoulder. No stream diversion or wetland fill is proposed.

Location

The proposed project is located on Bean Creek, a tributary of the San Lorenzo River in the county of Santa Cruz, California. Bean Creek, via Zayante Creek, flows into the mainstem of the San Lorenzo River in the town of Felton, California about 75 miles south from San Francisco. The San Lorenzo River drains an approximately 137-square mile watershed. The river drains to the Pacific Ocean at the north end of Monterey Bay.

The project area is located above the riparian corridor of Bean Creek. The project site is located at Post Mile 1.36 on Glenwood Road. See Location Map.

Type of Habitat Affected by Proposed Project

The primary wildlife habitat in the Bean Creek watershed in the vicinity of the project area is mixed hardwood and conifer forest with sandy soils and scattered ruderal grasslands. The riparian corridor at the site is predominantly coast redwood (*Sequoia sempervirens*) and big-leaf maple (*Acer macrofolia*). Adjacent upland slopes support a mix of redwood, tanoak (*Lithocarpus densiflorus*), big-leaf maple and California live oak (*Quercus agrifolia*).

The project impact area consists of the failed embankment above freshwater stream habitat within the road impinged riparian zone. No trees will be removed for the project. The land use in the project vicinity is rural residential and timber harvest preserve.

Aquatic habitat capable of supporting salmonids and California red-legged frogs is present in the vicinity of the proposed project site. Avoidance of this habitat to the extent possible will minimize potential impacts to these species.

Listed Species in the Project Area and Vicinity

The CNDDDB has listed 16 special status species with the potential to occur at or near the project area within the USGS Felton quad. Due to the proposed project's extremely small size

and location on the embankment of an established roadway, only three species have the potential to be in or near the project site. The CNDDDB-listed species are included in Table A.

The proposed project site is within the range of the California red-legged frog (*Rana aurora draytonii*- or "RLF") (Stebbins 1985, Jennings and Hayes 1994). The California red-legged frog is known from the Santa Cruz Mountains in Santa Cruz, San Mateo and Santa Clara Counties. California red-legged frog is known to occur in the upper watershed of the San Lorenzo River watershed in the Zayante subwatershed at Quail Hollow Park approx. 3.5 miles west of the project site and Mountain Charlie Gulch approx. 0.5 miles north of the project site (CNDDDB 2007; C. Berry – City of Santa Cruz Water Dept., pers. comm. 2004).

In 2005, KEC observed a juvenile CA red-legged frog in Bean Creek approximately 1 mile upstream of the proposed PM 1.36 project site. Anecdotal information provided by a former resident of the ridge between Mountain Charlie Gulch and Bean Creek revealed that a privately-owned pond off Mountain Charlie Gulch Road is the most likely breeding area for red-legged frogs, as they were frequently caught by children in the late 1950's through the 1960's. This pond is within 1 mile of the proposed project site. No recent, documented RLF observations have been made at the pond, however.

Elsewhere in the upper San Lorenzo River watershed, California red-legged frogs were reported in 1974 and 1975 in a spring box along a service road that was situated in the north end of Castle Rock State Park (Johnston, pers. comm.). One additional RLF observation record is from the Sempervirens Reservoir at Big Basin Redwoods State Park (Allaback, pers. comm.; Hyland, pers. comm.). Both California red-legged frogs and introduced bullfrogs (*Rana catesbeiana*) inhabit the reservoir at Big Basin.

Habitat for fish in vicinity of the Bean Creek repair site is good. NOAA Fisheries has listed the threatened Coho salmon (*Oncorhynchus kisutch*) and threatened steelhead (*O. mykiss*) as occurring in or around the project area. Both these species are known to occur in the San Lorenzo River Watershed, and their habitat is present at the project site. Coho are considered extremely rare in the San Lorenzo watershed and are unlikely to occur in the watershed.

Western pond turtles (*Clemmys marmorata*) are considered rare in the San Lorenzo River, although anecdotal observations on mainstem summer dams in the Boulder Creek area were made in the 1970's by valley residents (M. Stroud, pers. comm., 2005). One adult western pond turtle was observed swimming in the lower San Lorenzo between Water Street and the pedestrian bridge in 2002 (Kittleson, personal observation). No impacts to western pond turtles are anticipated.

No listed plants are present in the potential impact zone of the project site. Based on the proposed design and project location above sensitive habitat, no impacts to listed species are anticipated.

Other Wildlife Species

Wildlife effects associated with the proposed project are expected to be temporary. Wildlife species that use the Bean Creek riparian corridor are mobile species that would leave the area during construction and return when construction is completed. Birds that may live in and

around the project sites would also likely leave during construction and return when construction is completed.

No riparian vegetation will be removed during the project. All work will be conducted from the existing roadway surface

Water Circulation, Fluctuation, and Salinity Impacts

The San Lorenzo River is a freshwater system until it reaches the estuarine area downstream of the Water Street Bridge. The project site on Bean Creek is located in exclusively freshwater habitat in a tributary to the San Lorenzo River in the Zayante Creek subwatershed.

The proposed project is not expected to significantly change the water chemistry of the river. As conceived, no work will be conducted in the wetted perimeter of the low-flow channel. Installation and removal of silt fence and plywood debris fence may result in minor temporal disturbance and turbidity. This is not expected to change the chemistry of the river.

During construction, flow will not be altered. No temporary diversion will be required to the water around the construction site. The general pattern and flow of the river would not change. Therefore, construction activities would not be considered a significant adverse effect.

Suggested Best Management Practices

The following best management practices are suggested:

- Control of site runoff through during construction.
- Installation of temporary erosion and sedimentation control devices.
- Location of equipment and spoils in designated staging areas.
- Control of excavated materials to limit turbidity.
- Construction equipment should be maintained in proper operating condition to prevent leaks of oil or grease.

Suggested Mitigation Measures

1. A qualified biologist shall meet with the construction crew prior to beginning construction to conduct a worker training session on the biotic resources and protected species in the San Lorenzo River system.
2. A qualified biologist shall survey the project site for nesting birds, prior to site work if construction is planned before August 1.
3. A qualified biologist shall survey the project site for California red-legged frogs with 72 hours prior to initiation of site work. If any California red-legged frogs are observed during preconstruction surveys, USFWS-Ventura staff will be contacted and formally consulted before any ground disturbance is authorized.
4. A qualified biologist shall be on site during the initial site excavation efforts, as well as installation and removal of silt fence and debris fence.
5. Due to the proximity to known California red-legged frog observations, daily monitoring during construction shall be conducted by the biological monitor to document that

construction does not cause habitat degradation, excessive turbidity or adverse water quality conditions.

Cumulative Effects on the Aquatic Ecosystem

There would be no significant cumulative effects on the aquatic ecosystem due to this project. All of the effects described in this evaluation would be primarily temporary, minor in nature, or within acceptable limits. There are no known other concurrent projects in the Bean Creek or Zayante Creek subwatershed area that would contribute to cumulative adverse effects in the area.

Summary

As proposed, the eroding road embankment above the ordinary high water line and low flow channel would be temporarily affected during construction. Due to the distance from sensitive habitat and minor nature of the emergency repair project, potential adverse impacts to listed species and their essential habitat are considered unlikely or temporary. Preventative measures would be taken to ensure that fish and wildlife are avoided, relocated and/or unharmed at all times.

As, proposed, state water quality standards would not be violated. The proposed action would not violate the Toxic Effluent Standards of Section 307 of the Clean Water Act.