

COUNTY OF SANTA CRUZ PLANNING DEPARTMENT

NOTICE OF PENDING ACTION

APPL. #: 241229

APN: 079-101-18

Proposal to operate a new 2-bedroom residential vacation rental.
Requires a residential Vacation Rental Permit.

Property located at 11360 Berkeley Way, Brookdale, CA 95007.

OWNER: Tamara & Scott Kley Contini

APPLICANT: SAME

SUPERVISORIAL DISTRICT: 5

PLANNER: Fernanda Dias Pini, (831) 454-3119

EMAIL: Fernanda.DiasPini@santacruzcountycalifornia.gov

Comments must be received by 07/17/2024. A decision on the application will be made on or after **07/31/2024**.

Appeals must be submitted in writing, include the required fee, and be received at the Planning Department by 5:00 p.m. 2 weeks from the decision date. Information about the appeal process may be obtained by phone at (831) 454-2130 or by contacting the project planner listed above.

Issues that arise from the use of the property as a vacation rental should be reported to the emergency contact posted at the property and on the Planning Department website at www.sccoplanning.com under “Vacation Rentals”.

Vacation Rental emergency contact for this application is:

Name: Molly Heaster

Telephone #: 831-345-3445

Address: 11360-A Berkeley Way, Brookdale, CA 95007

Discussion with the emergency contact can resolve most issues.

Vacation rental applications are processed pursuant to Santa Cruz County Code section 13.10.694, also available at the Planning Department website.

5/25/2024

APN: 079-101-18

Owners:

Scott Kley Contini

415-596-6985 | scott.contini@gmail.com

Tamara Kley Contini

415-948-8260 | tkcontini@gmail.com

Kley Contini Vacation Rental

11360 Berkeley Way

Brookdale, CA

Site Plan

Scale: 1" = 30'

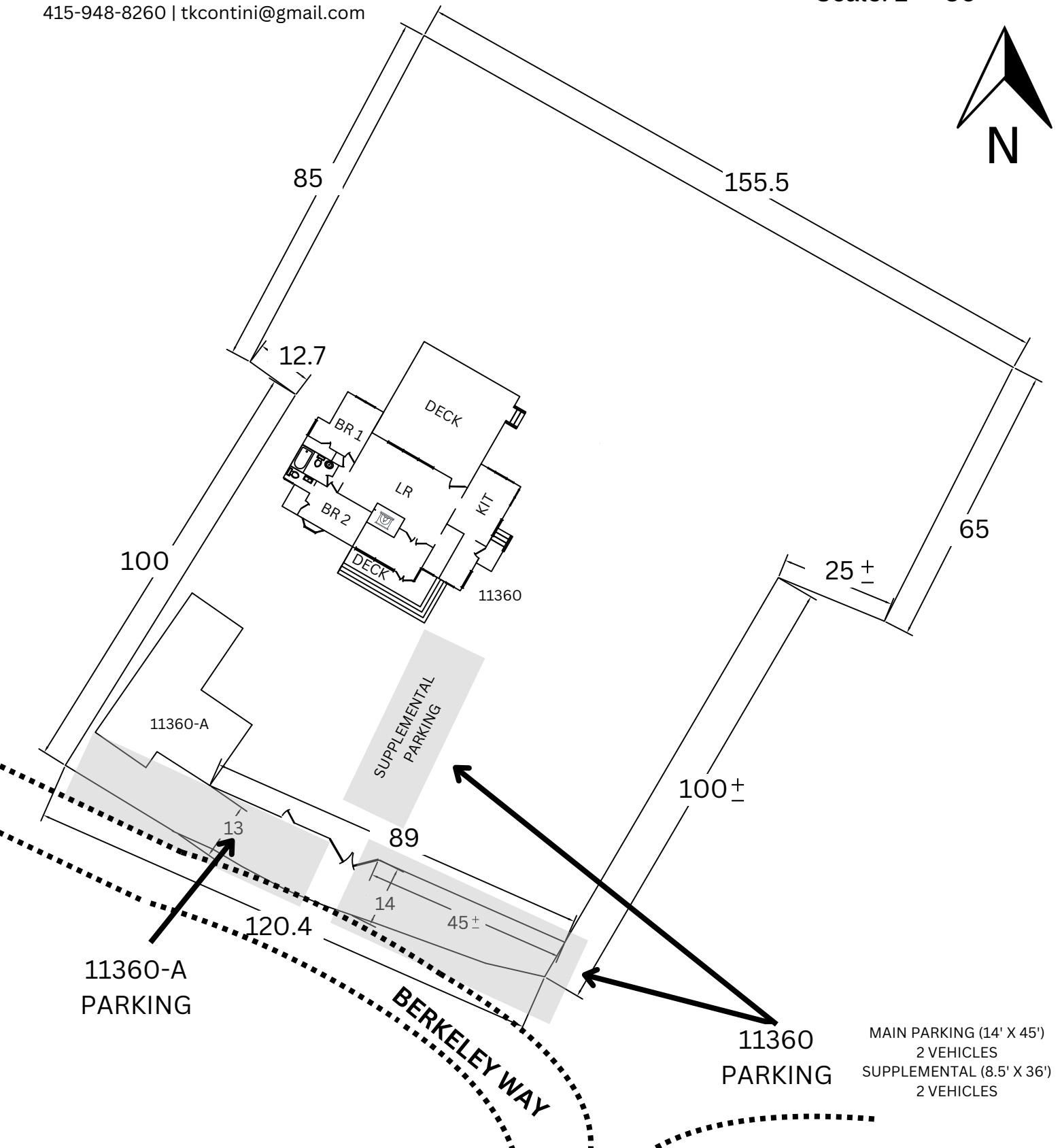

5/25/2024

APN: 079-101-18

Owners:

Scott Kley Contini

415-596-6985 | scott.contini@gmail.com

Tamara Kley Contini

415-948-8260 | tkcontini@gmail.com

Kley Contini Vacation Rental

11360 Berkeley Way

Brookdale, CA

Floor Plan

Scale: 1/8" = 1'

